



US007771483B2

(12) **United States Patent**  
**Justin et al.**

(10) **Patent No.:** **US 7,771,483 B2**  
(45) **Date of Patent:** **Aug. 10, 2010**

(54) **TIBIAL CONDYLAR HEMIPLASTY  
IMPLANTS, ANCHOR ASSEMBLIES, AND  
RELATED METHODS**

(75) Inventors: **Daniel F. Justin**, Logan, UT (US); **E. Marlowe Goble**, Alta, WY (US); **Joel Dever**, Nibley, UT (US); **Carlyle J. Creger**, Logan, UT (US); **Daniel J. Triplett**, Providence, UT (US)

(73) Assignee: **Zimmer, Inc.**, Warsaw, IN (US)

(\* ) Notice: Subject to any disclaimer, the term of this patent is extended or adjusted under 35 U.S.C. 154(b) by 18 days.

(21) Appl. No.: **10/749,346**

(22) Filed: **Dec. 30, 2003**

(65) **Prior Publication Data**

US 2005/0143831 A1 Jun. 30, 2005

(51) **Int. Cl.**  
**A61F 2/38** (2006.01)

(52) **U.S. Cl.** ..... **623/20.34**

(58) **Field of Classification Search** ..... 623/20.17, 623/20.3, 20.31, 20.16, 23.14, 23.12, 23.26, 623/14.12, 11.11, 16.11, 20.14, 20.15, 20.32–20.34, 623/20.25, 20.26, 20.35, 20.36; 606/96  
See application file for complete search history.

(56) **References Cited**

U.S. PATENT DOCUMENTS

- 4,000,525 A 1/1977 Klawitter et al.
- 4,224,696 A 9/1980 Murray et al.
- 4,479,271 A 10/1984 Bolesky et al.
- 4,502,161 A 3/1985 Wall
- 4,627,853 A 12/1986 Campbell et al.

- 4,657,549 A 4/1987 Keller
- 4,673,407 A 6/1987 Martin
- 4,838,891 A 6/1989 Branemark et al.
- 4,927,421 A 5/1990 Goble et al.
- 5,019,103 A \* 5/1991 Van Zile et al. .... 623/20.34
- 5,035,699 A 7/1991 Coates
- 5,037,439 A 8/1991 Albrektsson et al.
- 5,092,895 A 3/1992 Albrektsson et al.
- 5,100,409 A 3/1992 Coates et al.
- 5,176,684 A 1/1993 Ferrante et al.
- 5,282,868 A 2/1994 Bahler
- 5,474,559 A 12/1995 Bertin et al.
- 5,489,311 A \* 2/1996 Cipolletti ..... 623/20.34
- 5,569,259 A 10/1996 Ferrante et al.
- 5,571,196 A 11/1996 Stein
- 5,593,411 A 1/1997 Stalcup et al.
- 5,674,224 A 10/1997 Howell et al.
- 5,702,397 A 12/1997 Goble et al.

(Continued)

FOREIGN PATENT DOCUMENTS

DE 3 917 285 11/1990

(Continued)

*Primary Examiner*—Alvin J Stewart  
(74) *Attorney, Agent, or Firm*—Baker & Daniels LLP

(57) **ABSTRACT**

A method for mounting a tibial condylar implant includes forming a tunnel having a proximal end on a lateral, medial, or anterior side of a proximal end of the tibia and a distal end on an at least partially resected lateral or medial facet at the proximal end of the tibia. A condylar implant is positioned over the distal end of the tunnel. A fastener is advanced into the tunnel from the proximal end of the tunnel. The fastener which is at least partially disposed within the tunnel is secured to the condylar implant.

**33 Claims, 27 Drawing Sheets**

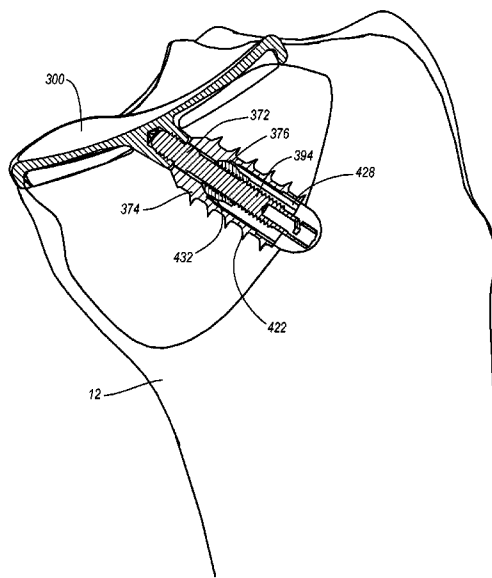

U.S. PATENT DOCUMENTS			2002/0147498 A1 10/2002 Tallarida et al.		
5,702,459 A	12/1997	Hummer et al.	2002/0198528 A1	12/2002	Engh et al.
5,709,689 A	1/1998	Ferrante et al.	2003/0033018 A1	2/2003	Merchant
5,741,262 A *	4/1998	Albrektsson et al. .... 606/80	2003/0060887 A1	3/2003	Ek
5,743,915 A	4/1998	Bertin et al.	2003/0120276 A1	6/2003	Tallarida et al.
5,755,800 A	5/1998	O'Neil et al.	2003/0158606 A1	8/2003	Coon et al.
5,766,255 A	6/1998	Slamin et al.	2003/0225456 A1	12/2003	Ek
5,769,855 A	6/1998	Bertin et al.	2003/0225457 A1	12/2003	Justin et al.
5,776,201 A	7/1998	Colleran et al.	2004/0015170 A1	1/2004	Tallarida et al.
5,824,098 A	10/1998	Stein	2004/0106928 A1 *	6/2004	Ek ..... 606/96
5,860,981 A	1/1999	Bertin et al.	2004/0148030 A1	7/2004	Ek
5,879,391 A	3/1999	Slamin	2005/0137708 A1	6/2005	Clark
5,968,045 A	10/1999	Frazier	2005/0143831 A1	6/2005	Justin et al.
6,068,648 A	5/2000	Cole et al.	2005/0149044 A1	7/2005	Justin et al.
6,071,311 A	6/2000	O'Neil et al.	2005/0154398 A1	7/2005	Miniaci et al.
6,102,954 A *	8/2000	Albrektsson et al. .... 623/20.32	2005/0177242 A1	8/2005	Lotke
6,162,234 A	12/2000	Freedland et al.	FOREIGN PATENT DOCUMENTS		
6,168,629 B1	1/2001	Timoteo	EP	0 336 774 B1	10/1989
6,171,342 B1	1/2001	O'Neil et al.	EP	0 714 645 B1	6/1996
6,245,110 B1 *	6/2001	Grundei et al. .... 623/20.31	EP	0 850 606 A2	7/1998
6,319,271 B1	11/2001	Schwartz et al.	EP	0 985 386 A2	3/2000
6,368,326 B1	4/2002	Dakin et al.	FR	2 521 421	11/1975
6,461,373 B2	10/2002	Wyman et al.	FR	2 682 589	4/1993
6,520,964 B2	2/2003	Tallarida et al.	FR	2 718 953	10/1995
6,544,267 B1	4/2003	Cole et al.	GB	2 007 980 A	5/1979
6,554,838 B2	4/2003	McGovern et al.	WO	WO 89/09578 A1	10/1989
6,610,067 B2	8/2003	Tallarida et al.	WO	WO 89/11837	12/1989
6,652,587 B2	11/2003	Felt et al.	WO	WO 91/06260	5/1991
6,679,917 B2	1/2004	Ek	WO	WO 01/28457 A1	4/2001
6,736,819 B2	5/2004	Tipirneni	WO	WO 01/66021 A1	9/2001
6,866,683 B2 *	3/2005	Gerbec et al. .... 623/18.11	WO	WO 01/66022 A1	9/2001
6,905,514 B2	6/2005	Carignan et al.	WO	WO 03/051210 A2	6/2003
6,994,725 B1	2/2006	Goble	WO	WO 03/051211 A1	6/2003
7,250,061 B2	7/2007	Jacobsson et al.	WO	WO 03/099159 A2	12/2003
2002/0055783 A1	5/2002	Tallarida et al.			
2002/0138150 A1	9/2002	Leclercq			

\* cited by examiner

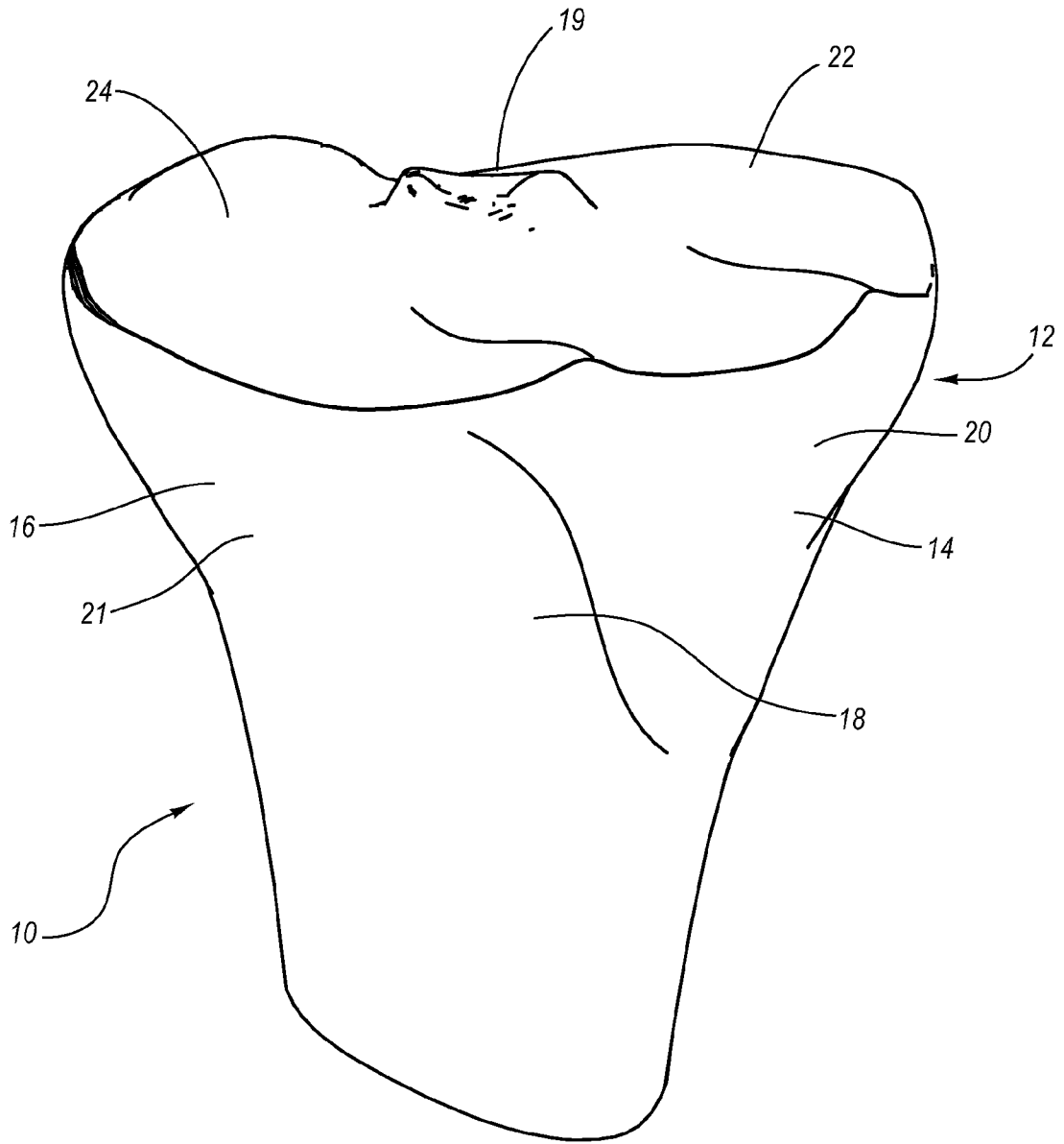
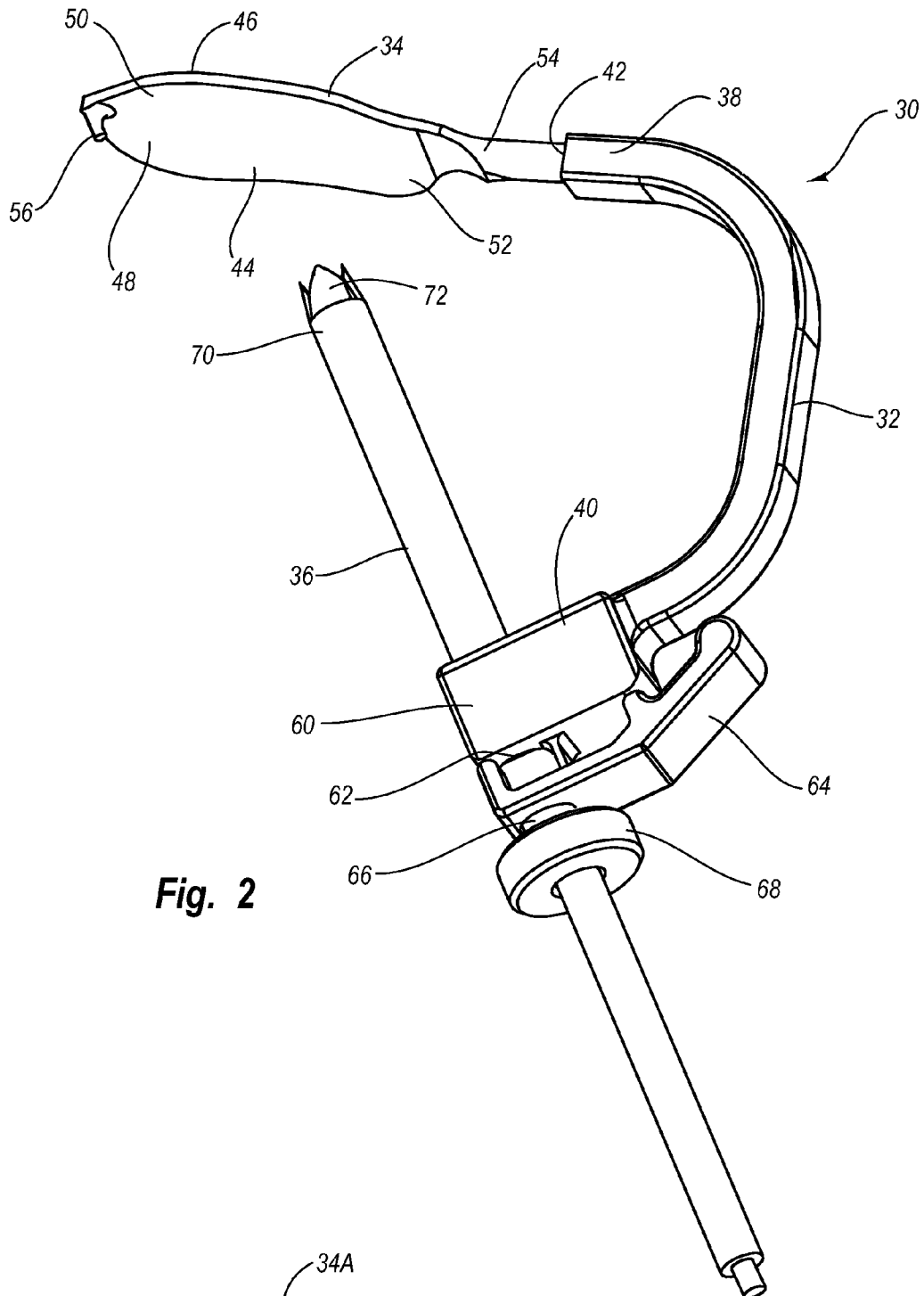
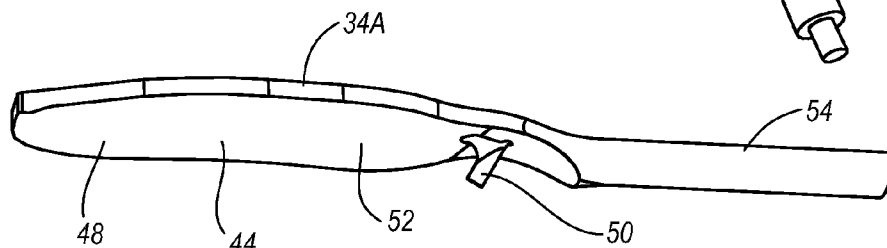

Fig. 1



**Fig. 2**



**Fig. 2A**

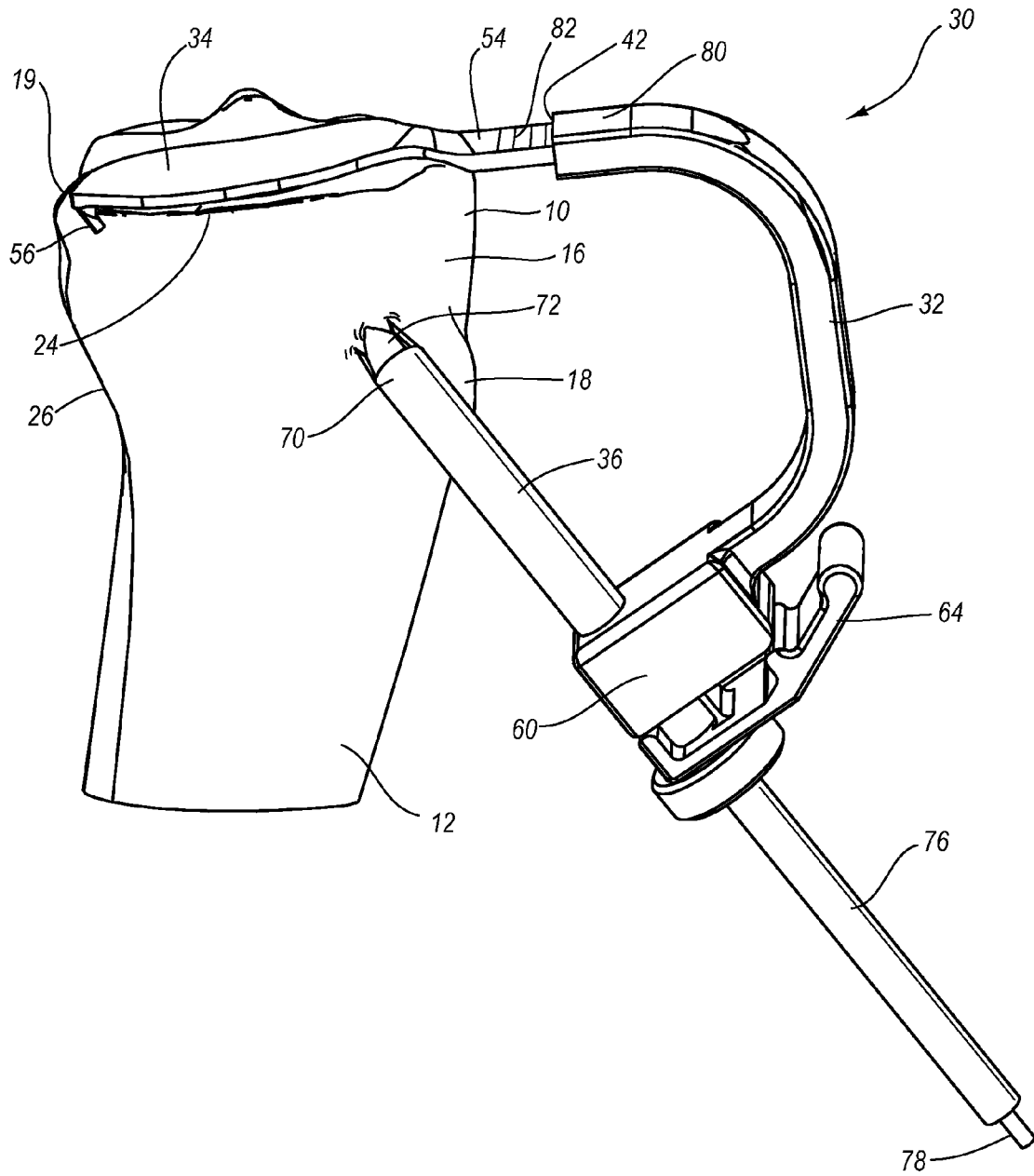

Fig. 3

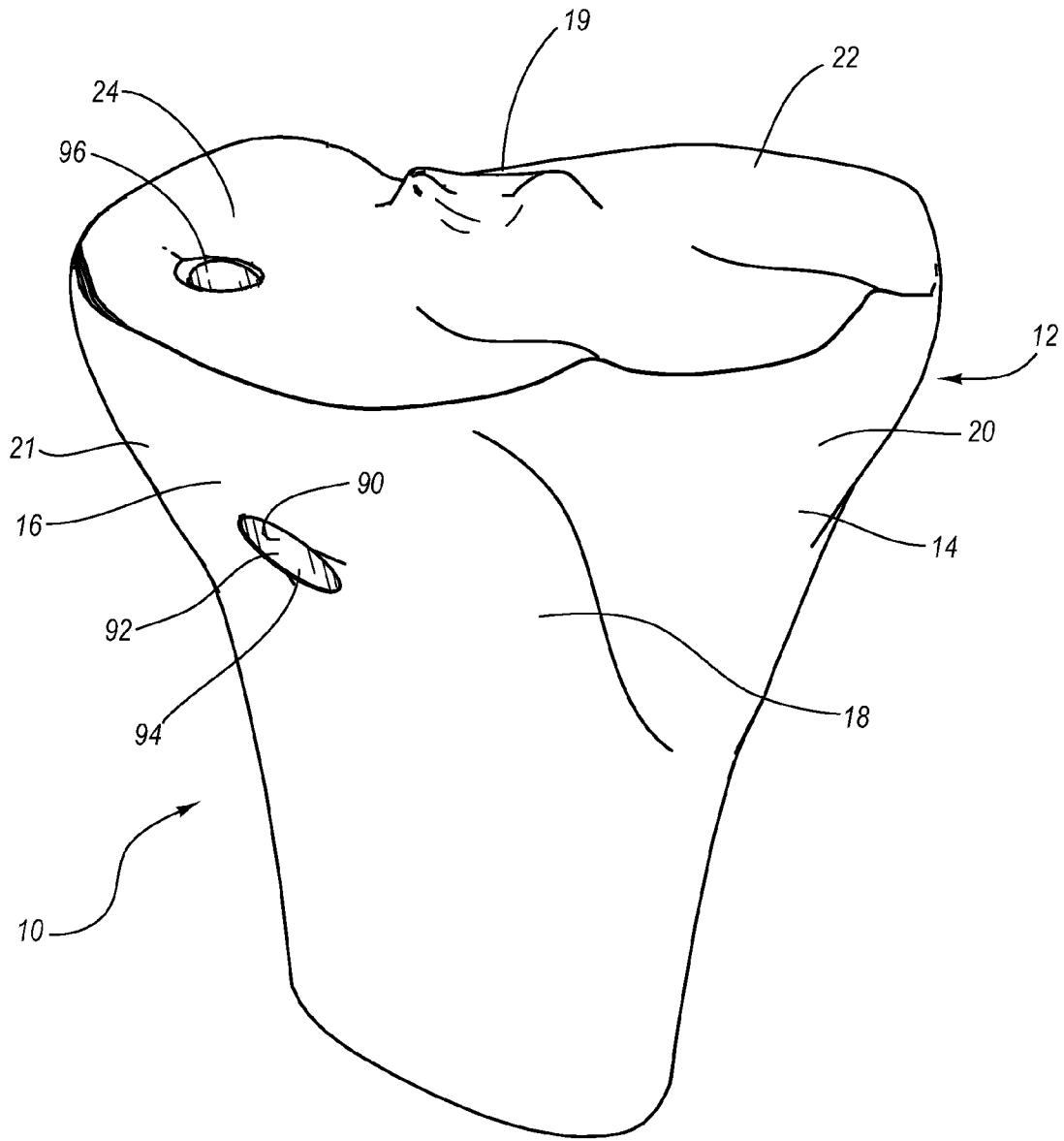

Fig. 4

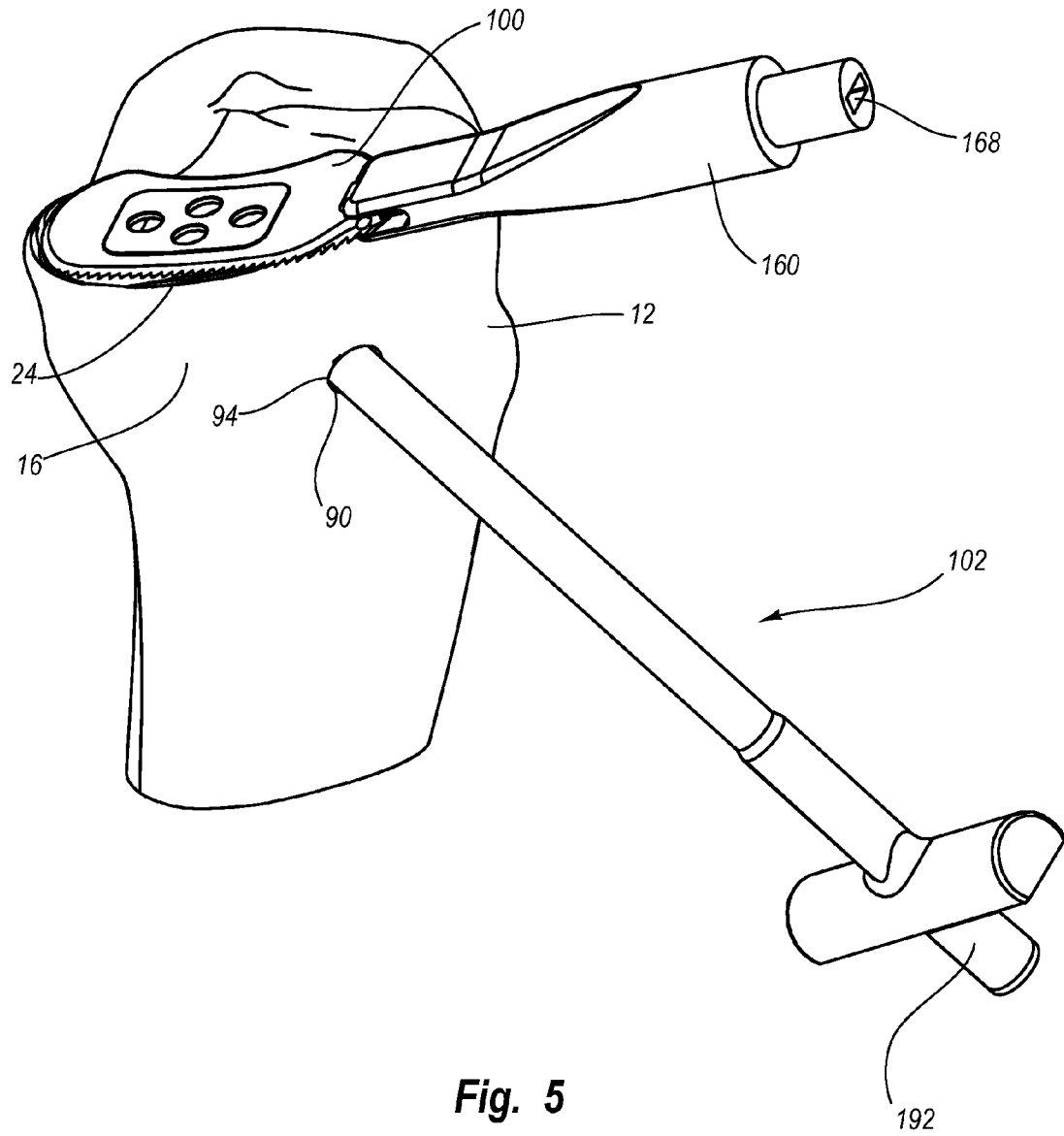

Fig. 5

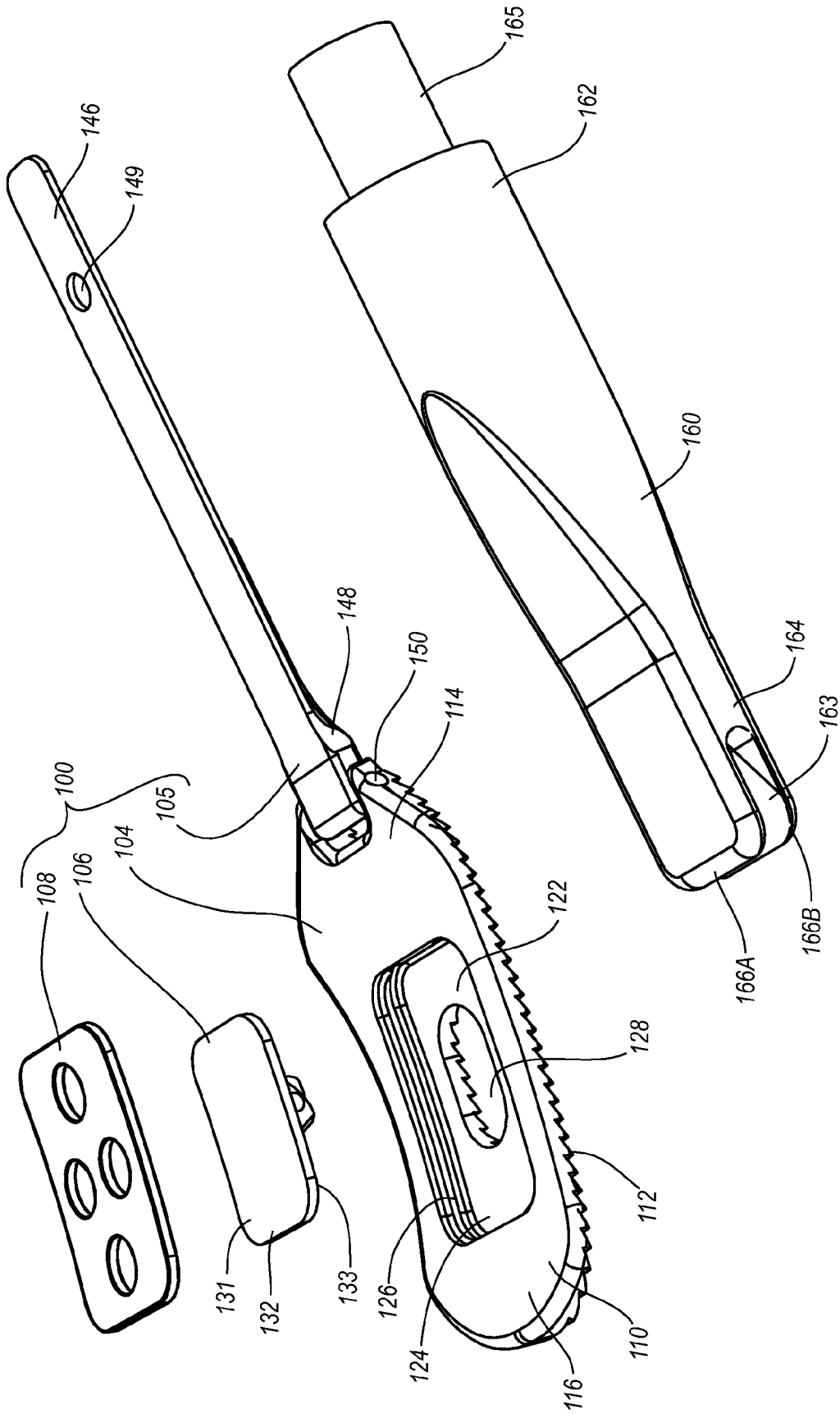

Fig. 6

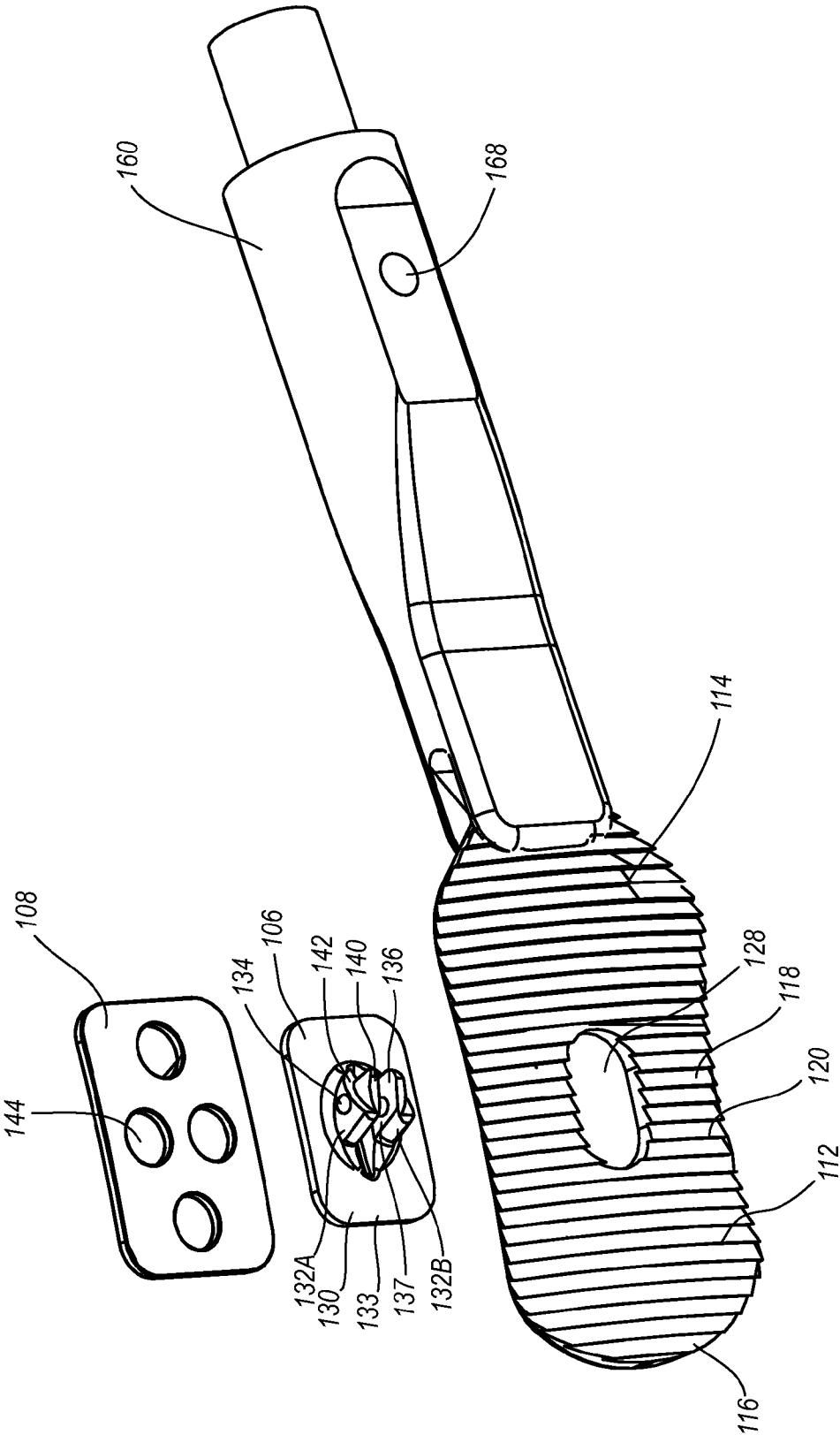

Fig. 7

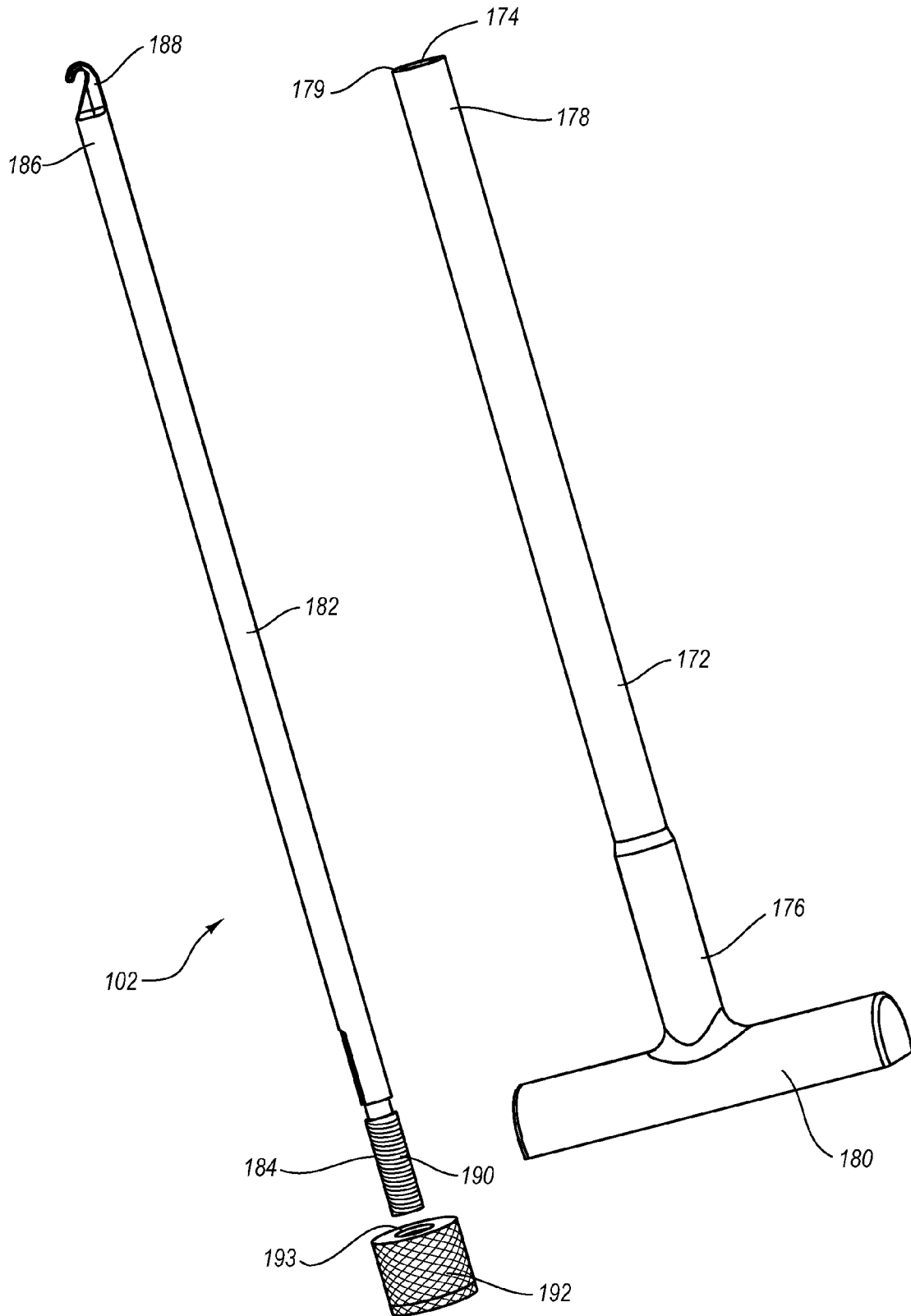

Fig. 8

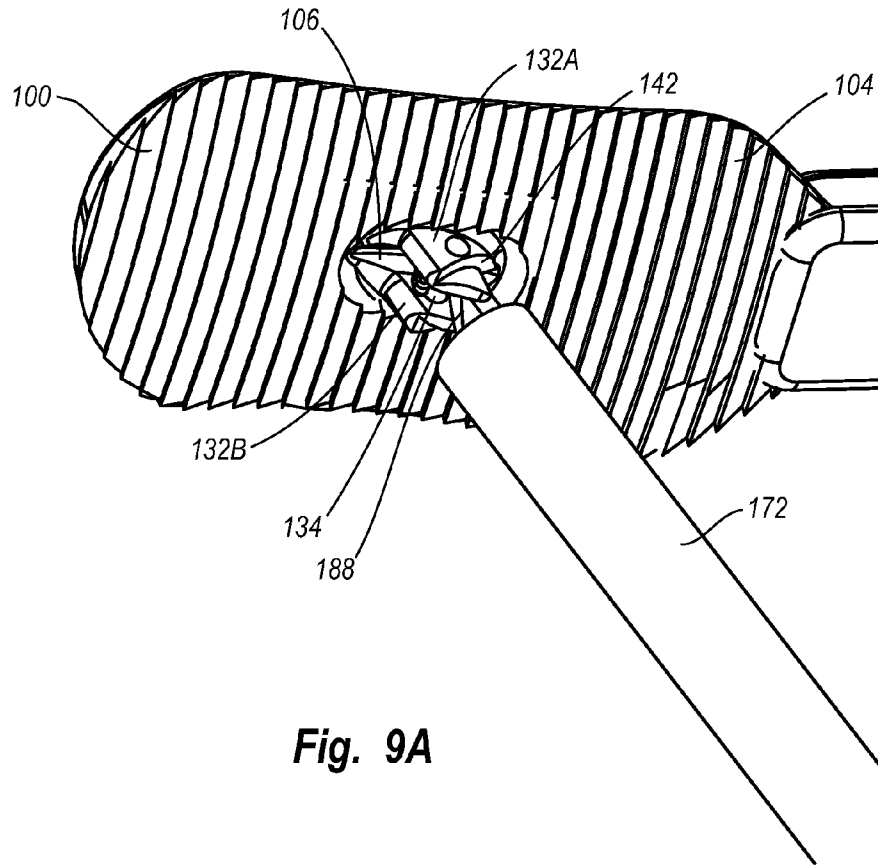

Fig. 9A

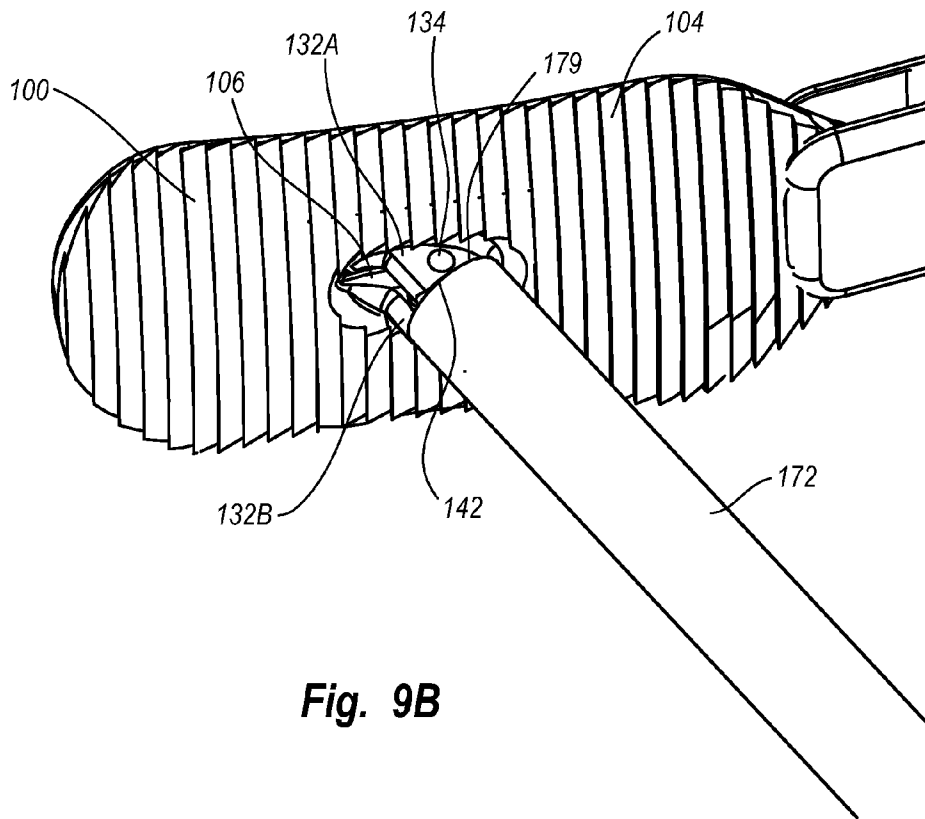

Fig. 9B

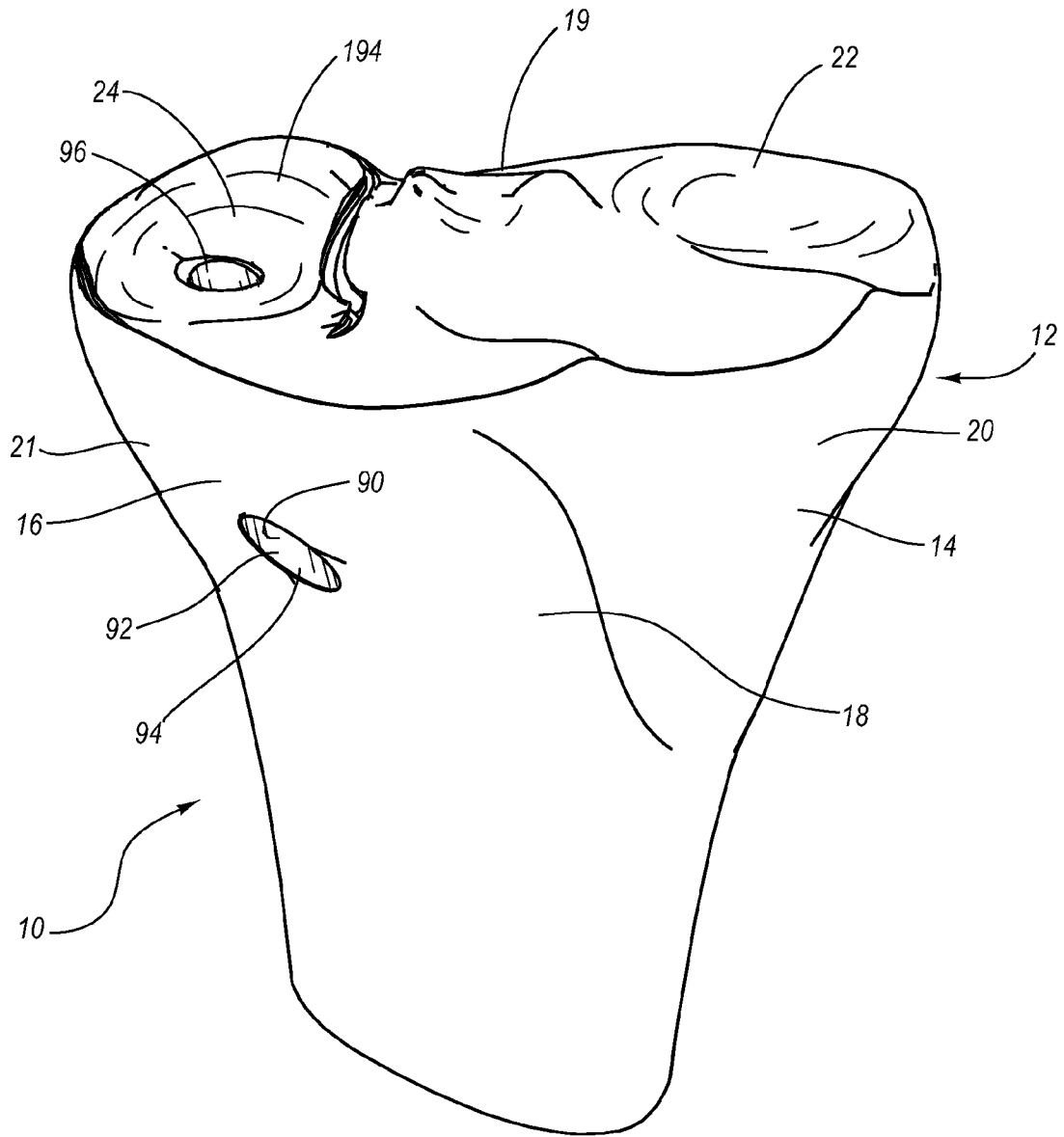

Fig. 10

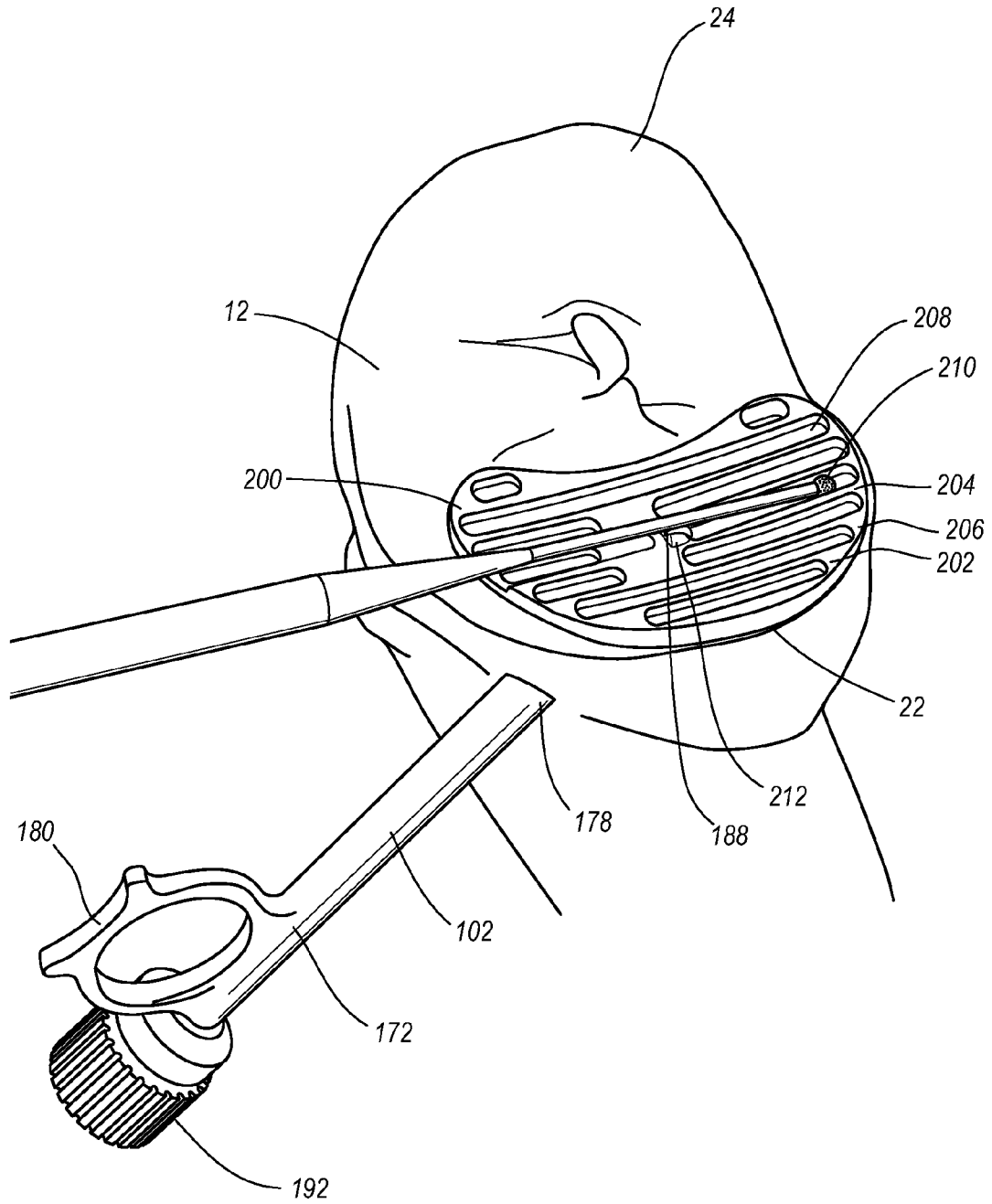
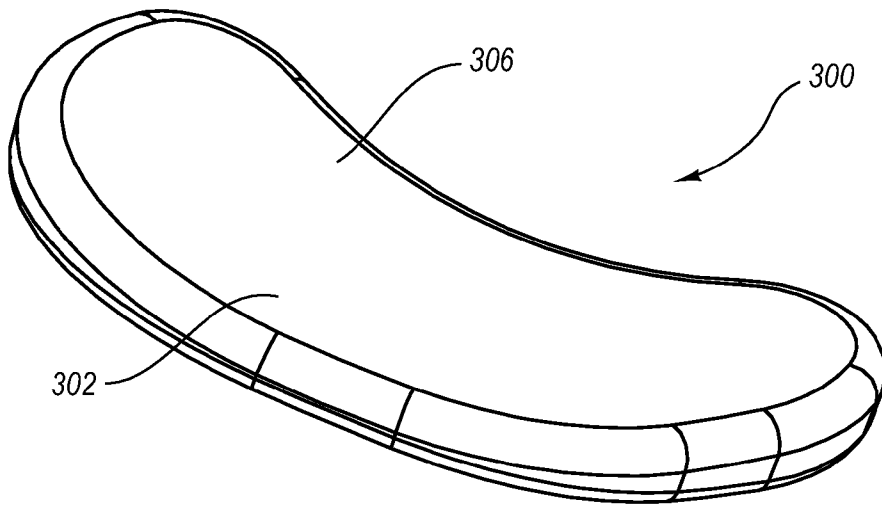
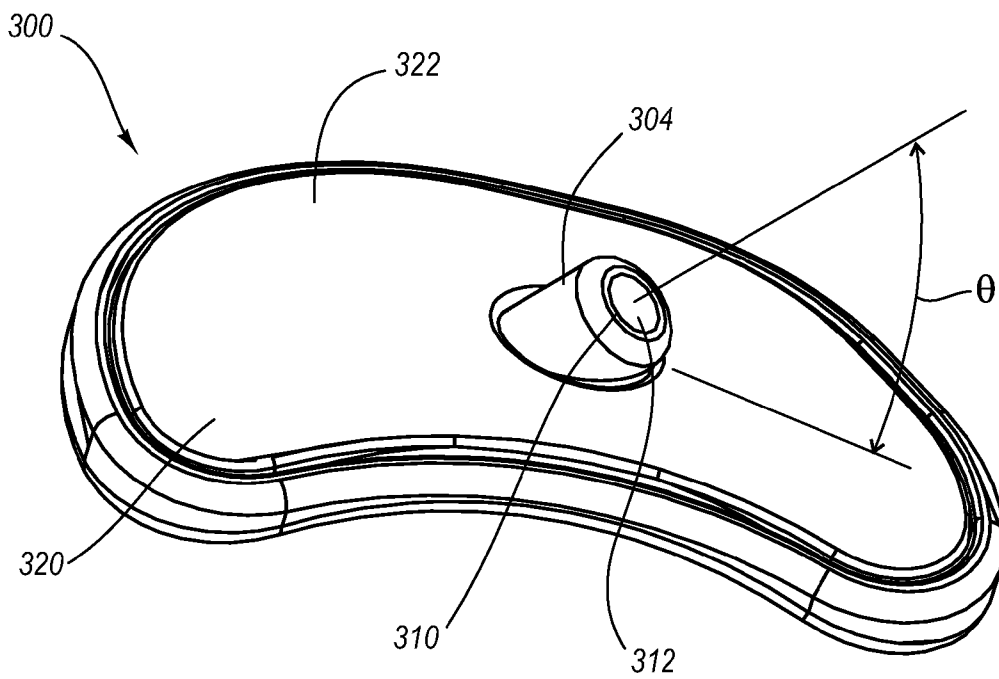

Fig. 11



**Fig. 12A**



**Fig. 12B**

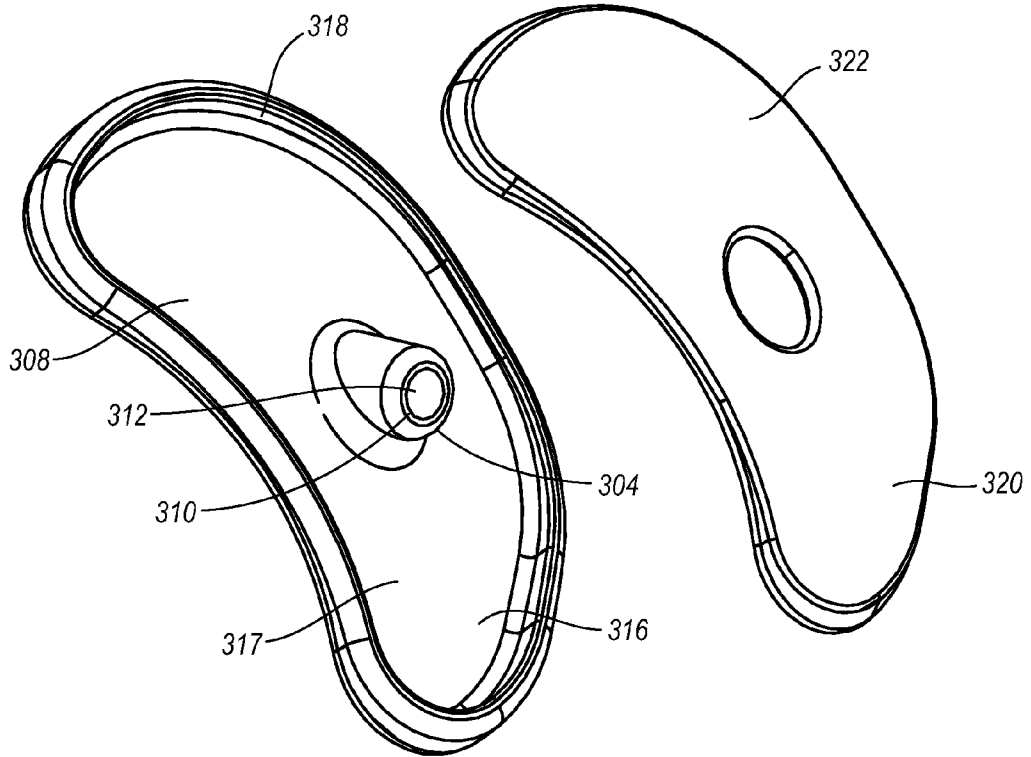

Fig. 12C

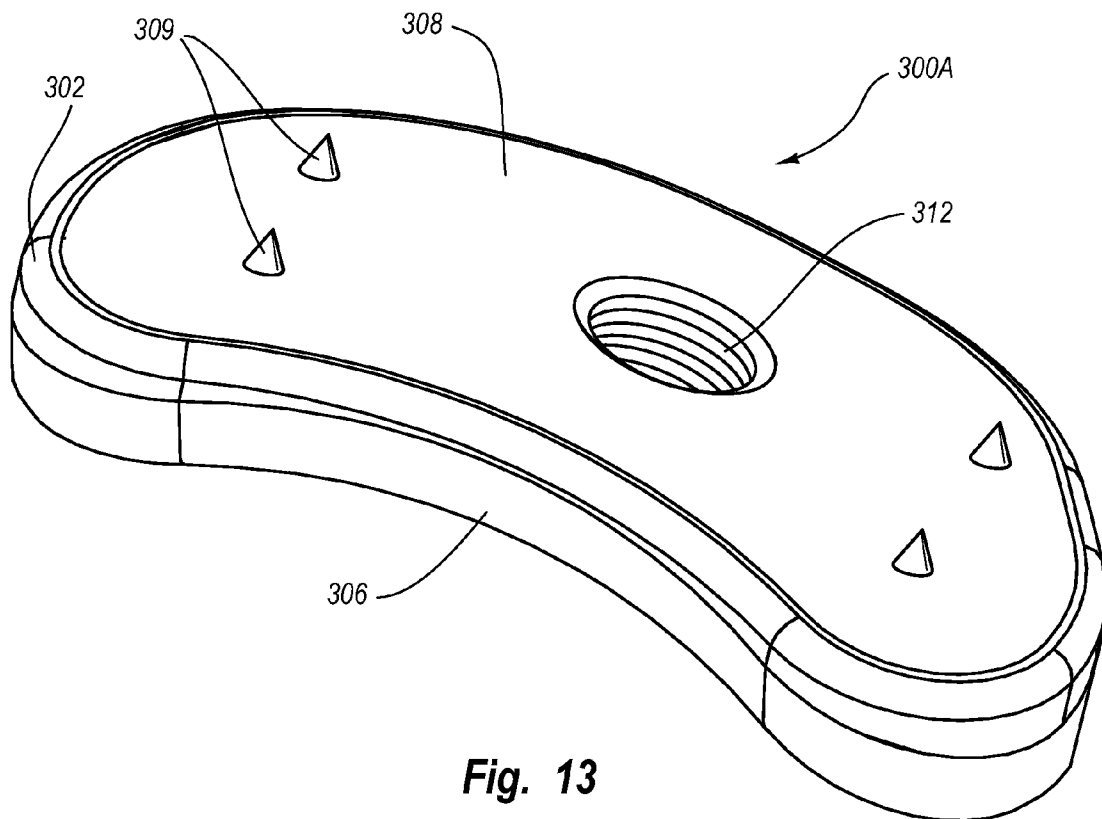

Fig. 13

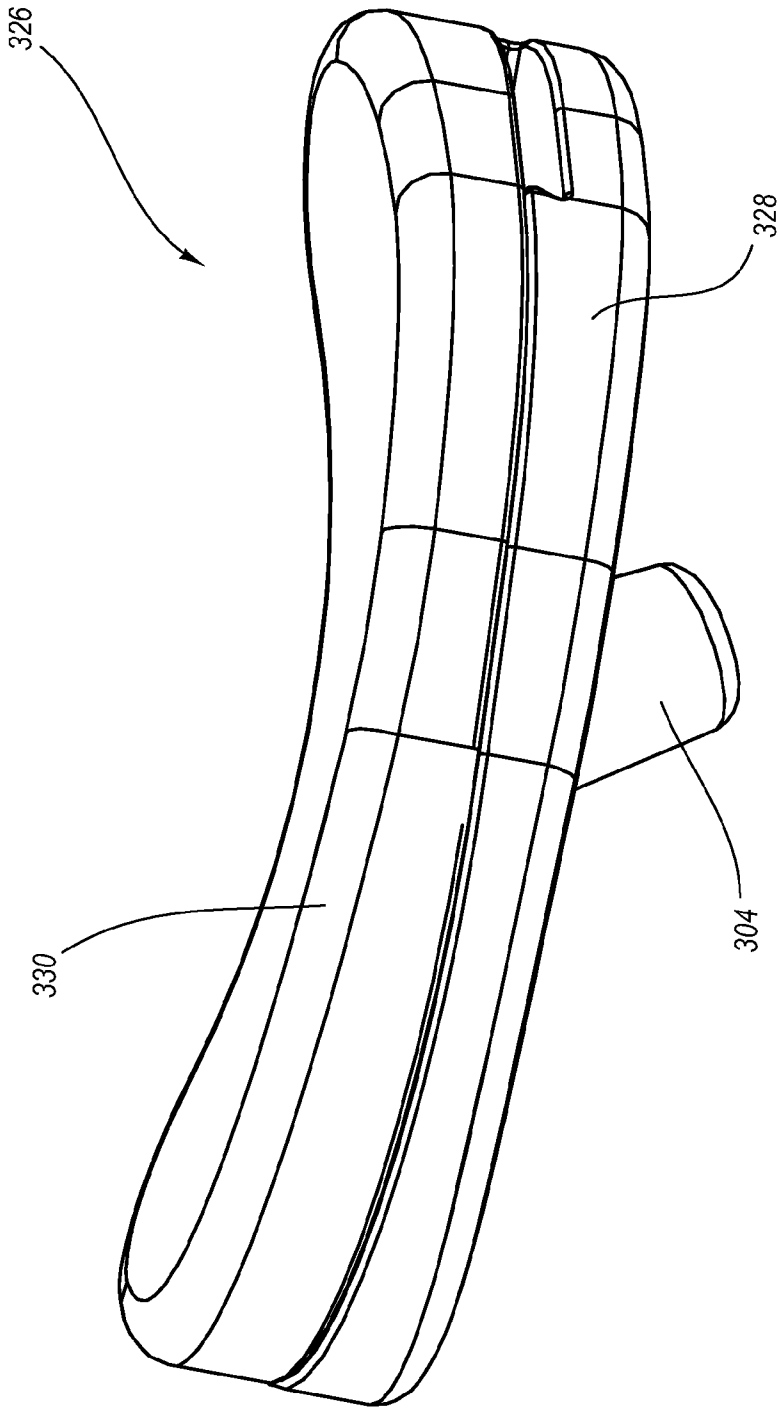
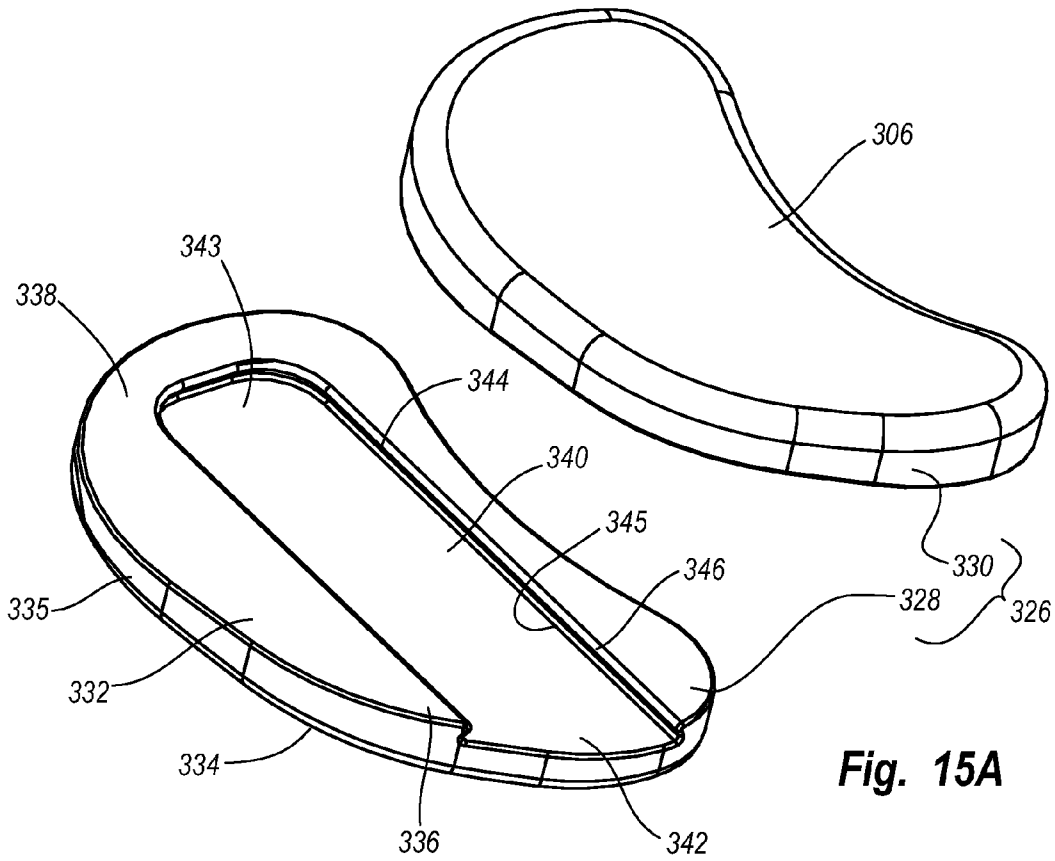
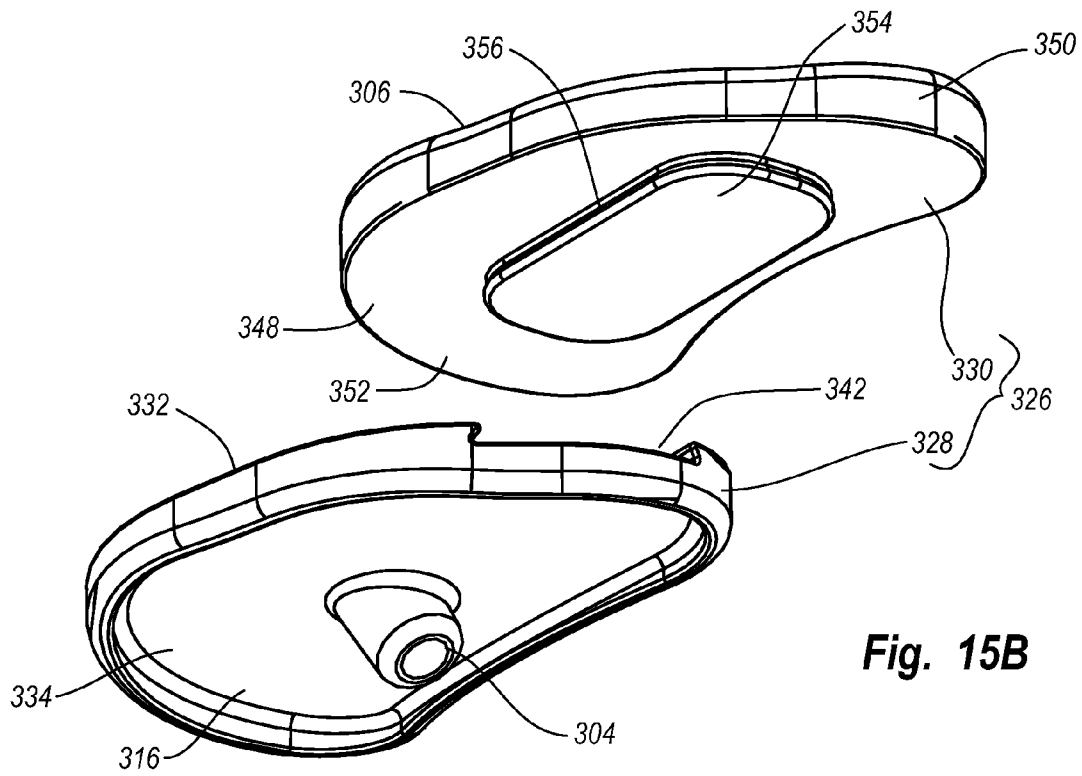

Fig. 14



**Fig. 15A**



**Fig. 15B**

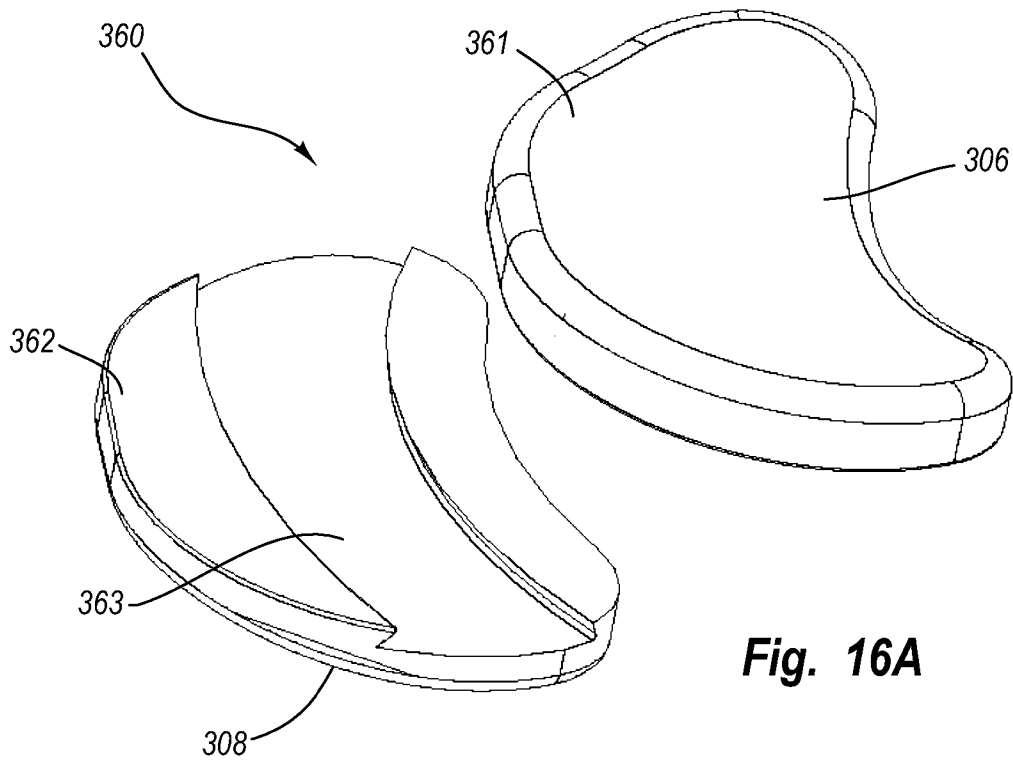

**Fig. 16A**

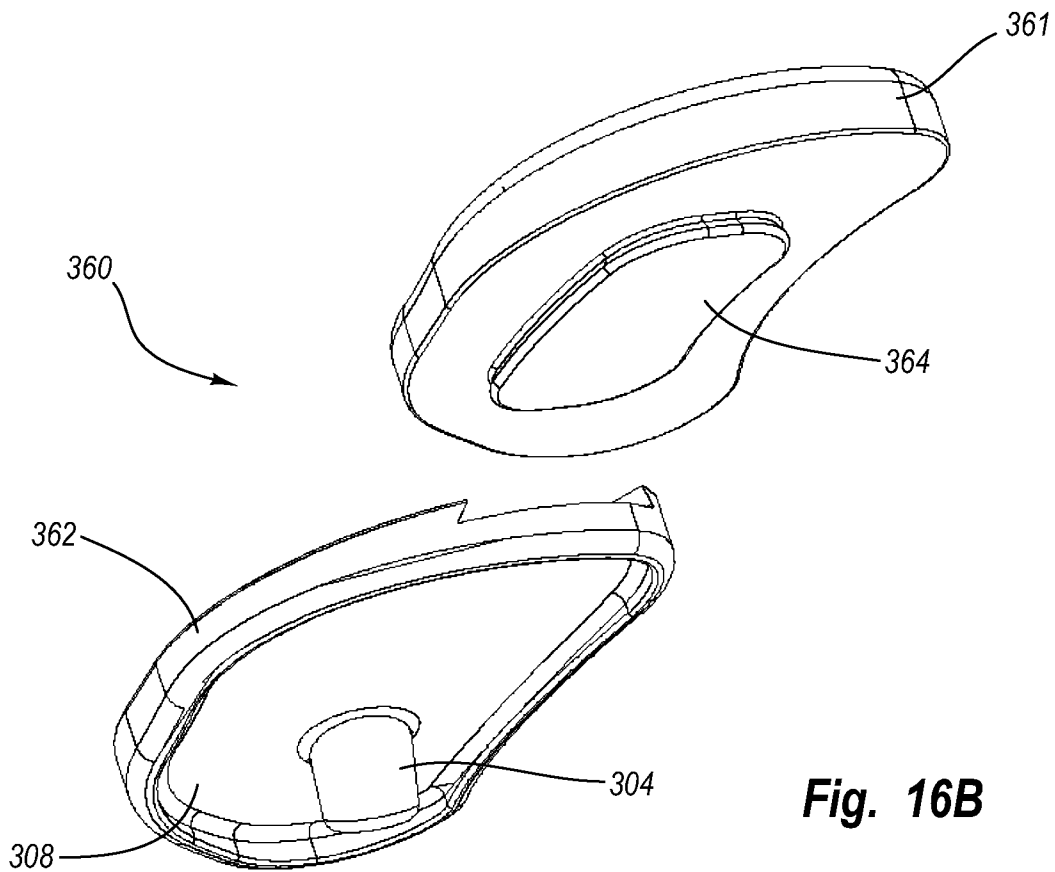

**Fig. 16B**

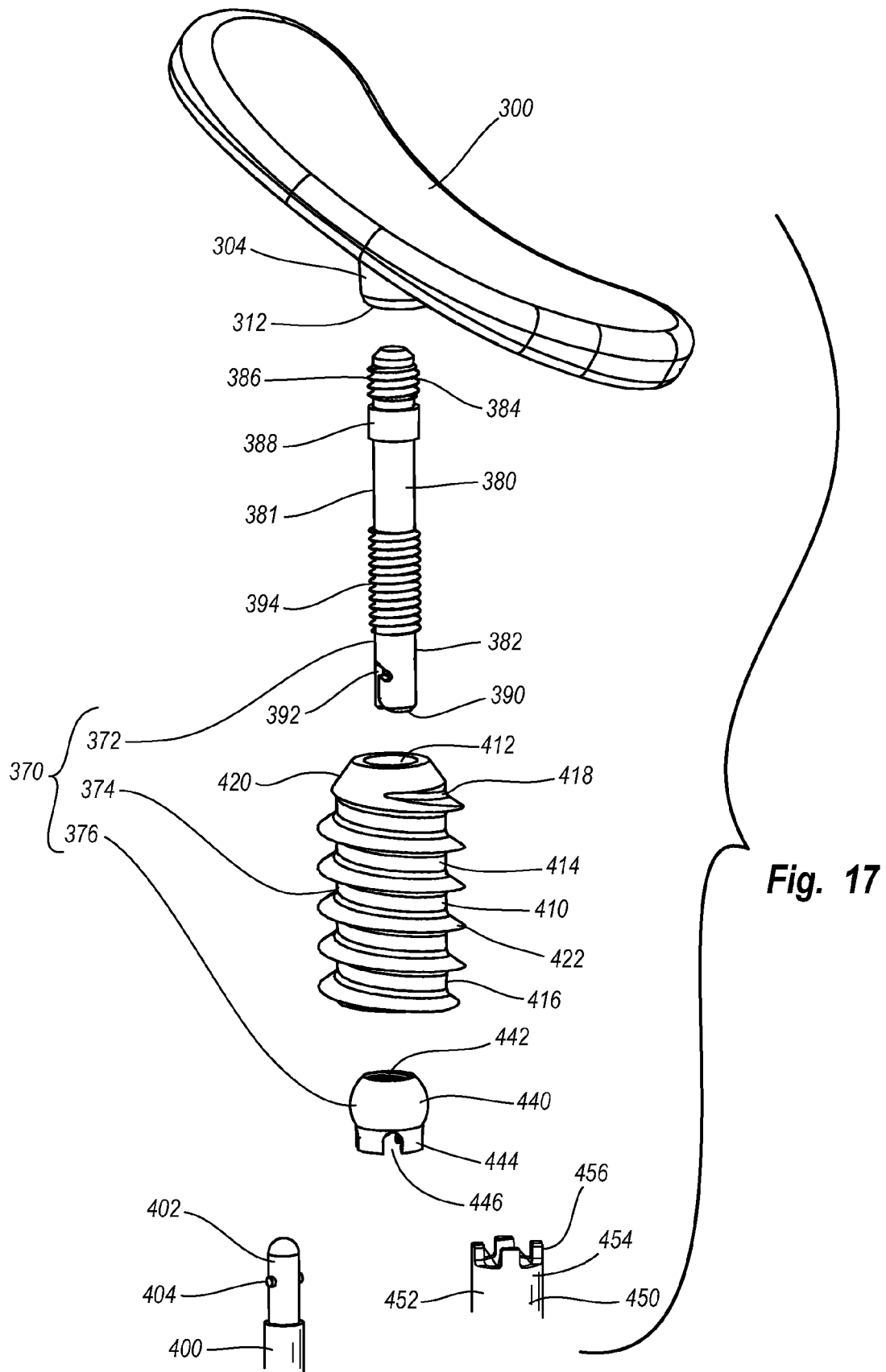

Fig. 17

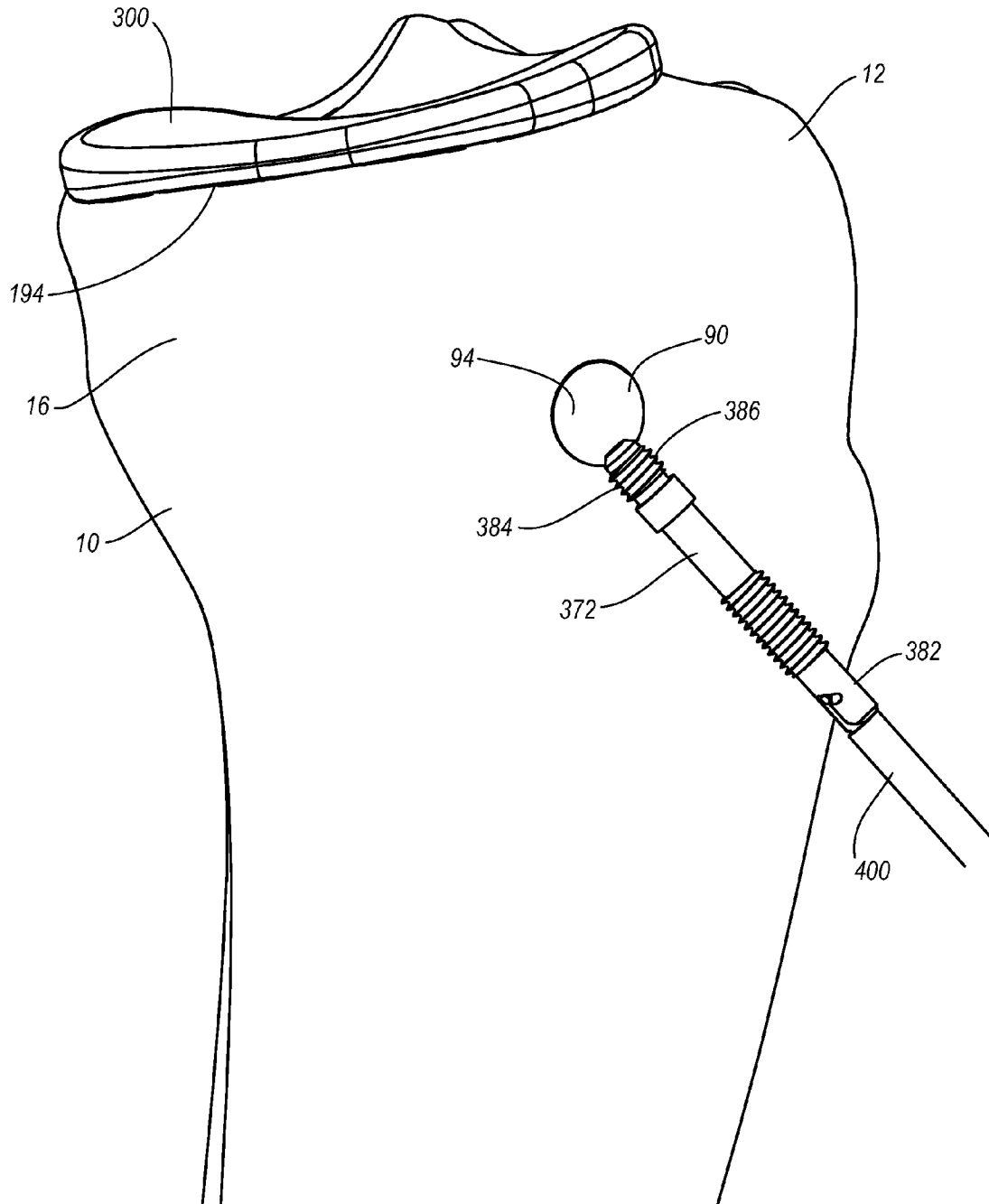

Fig. 18

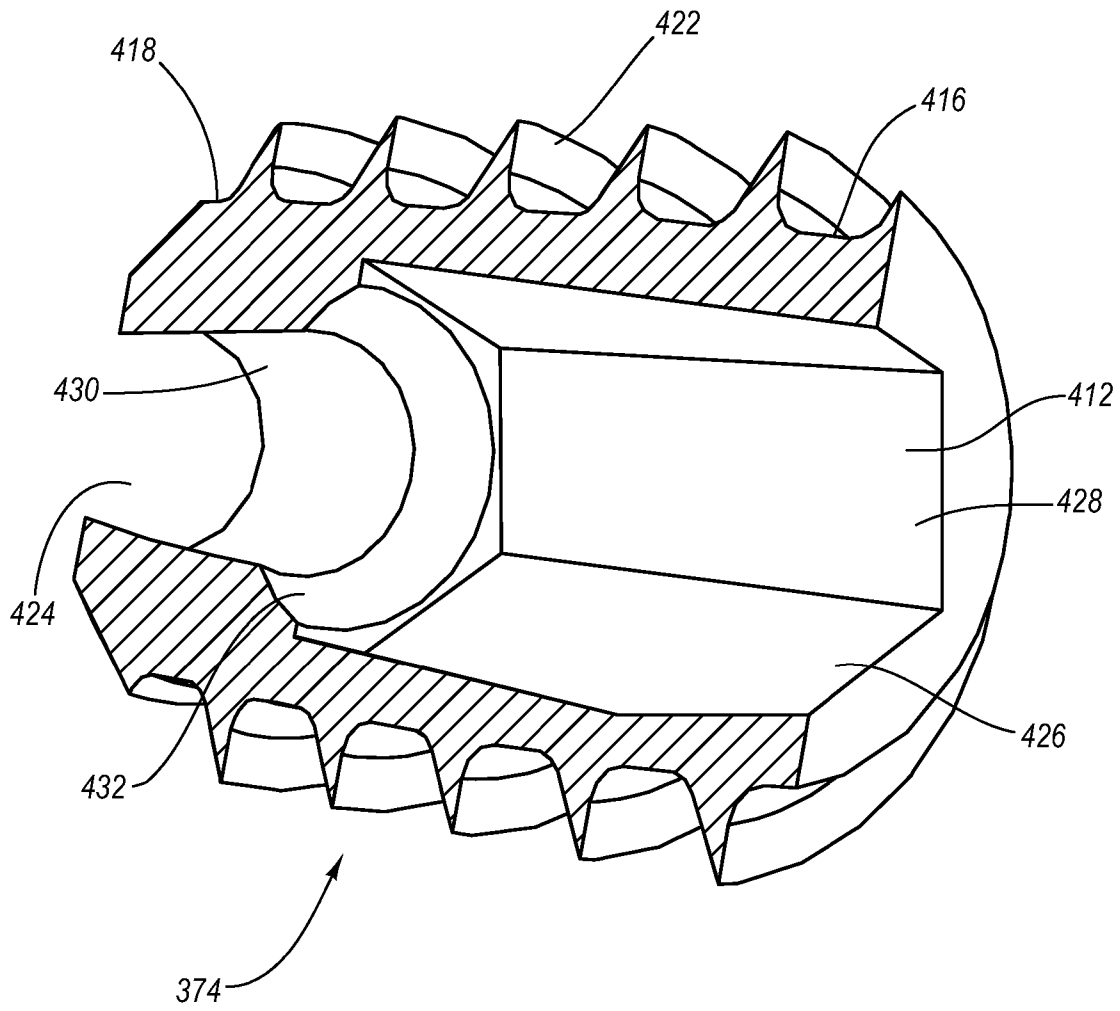

Fig. 19

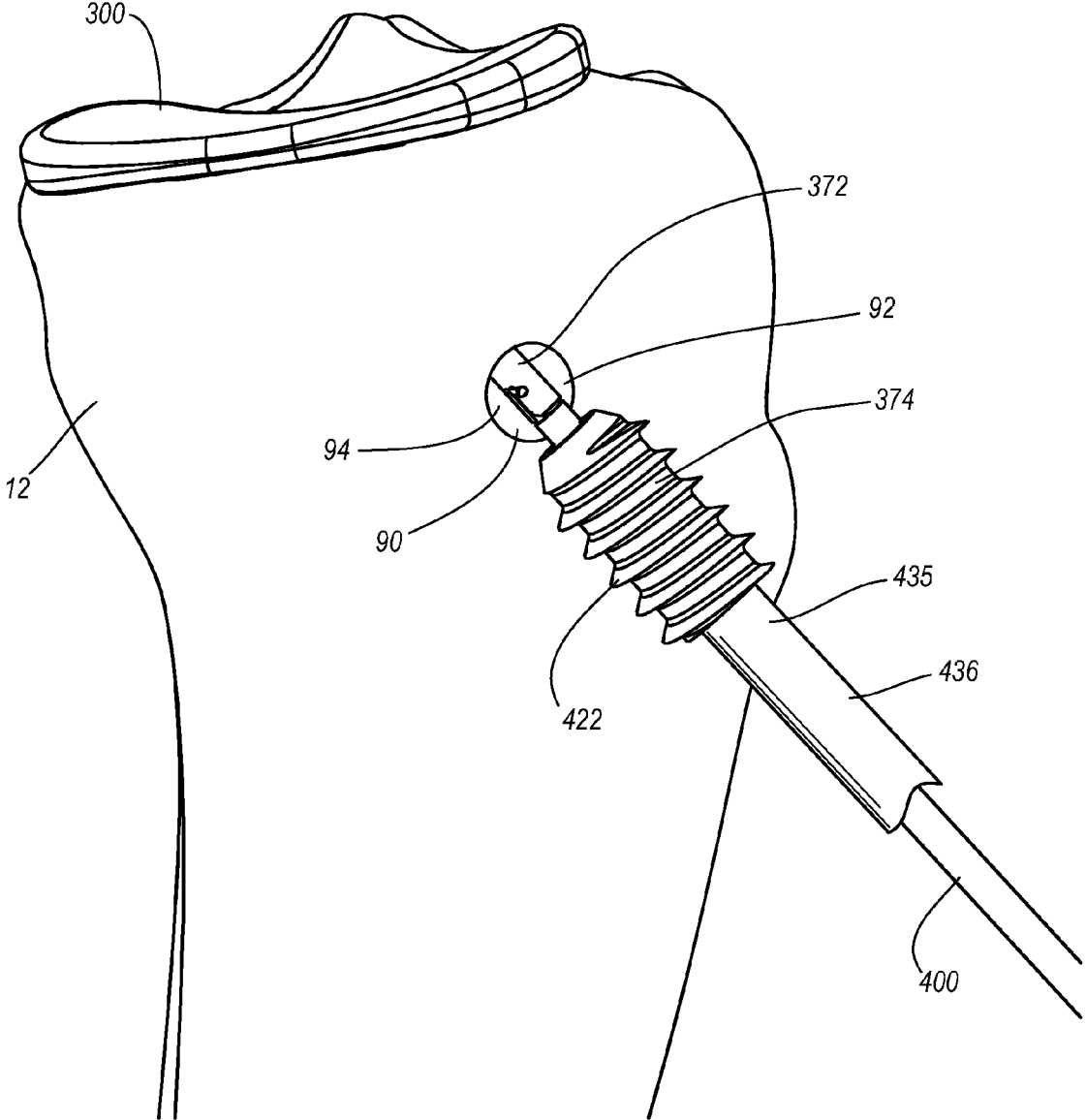

Fig. 20

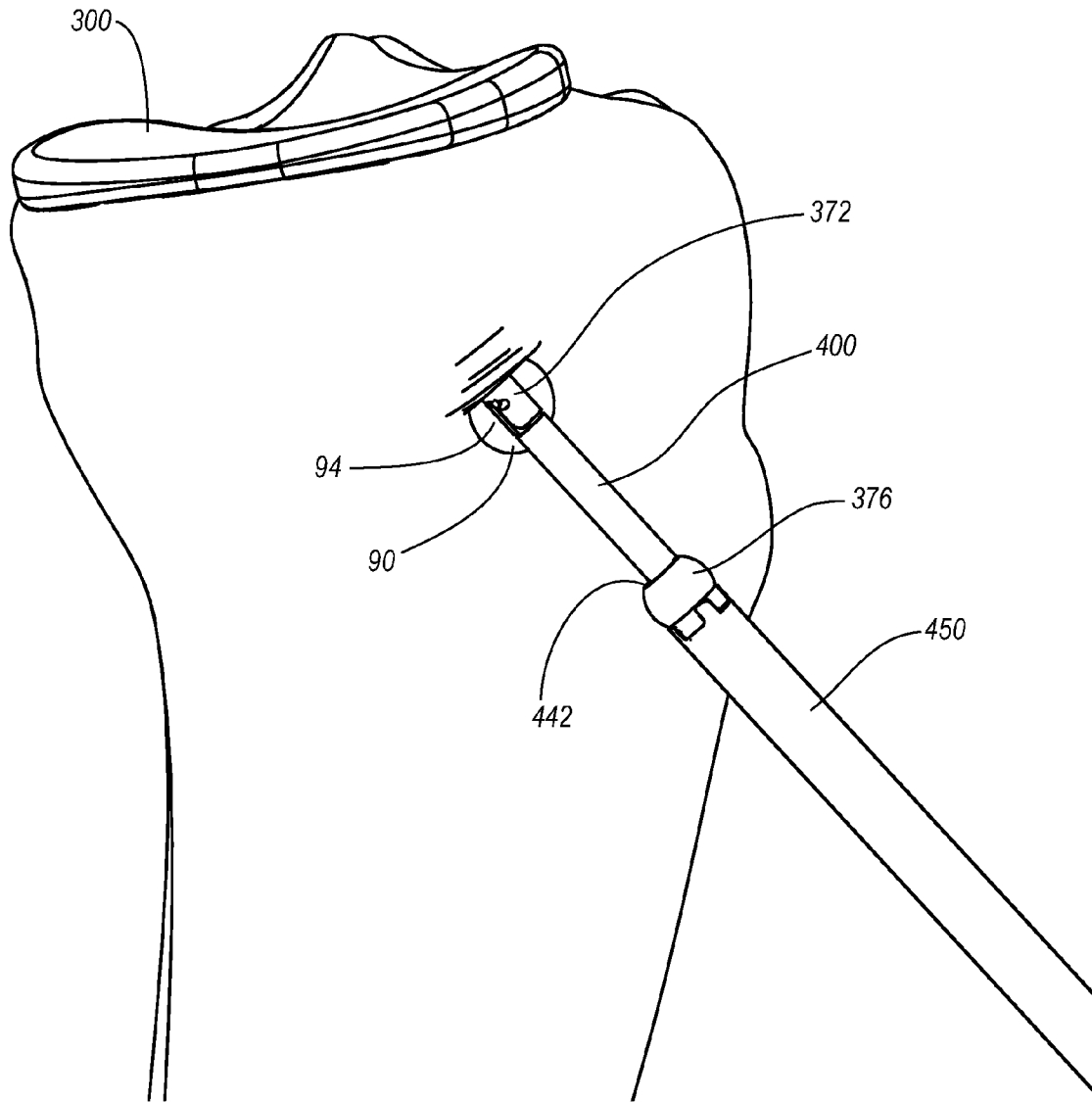

Fig. 21

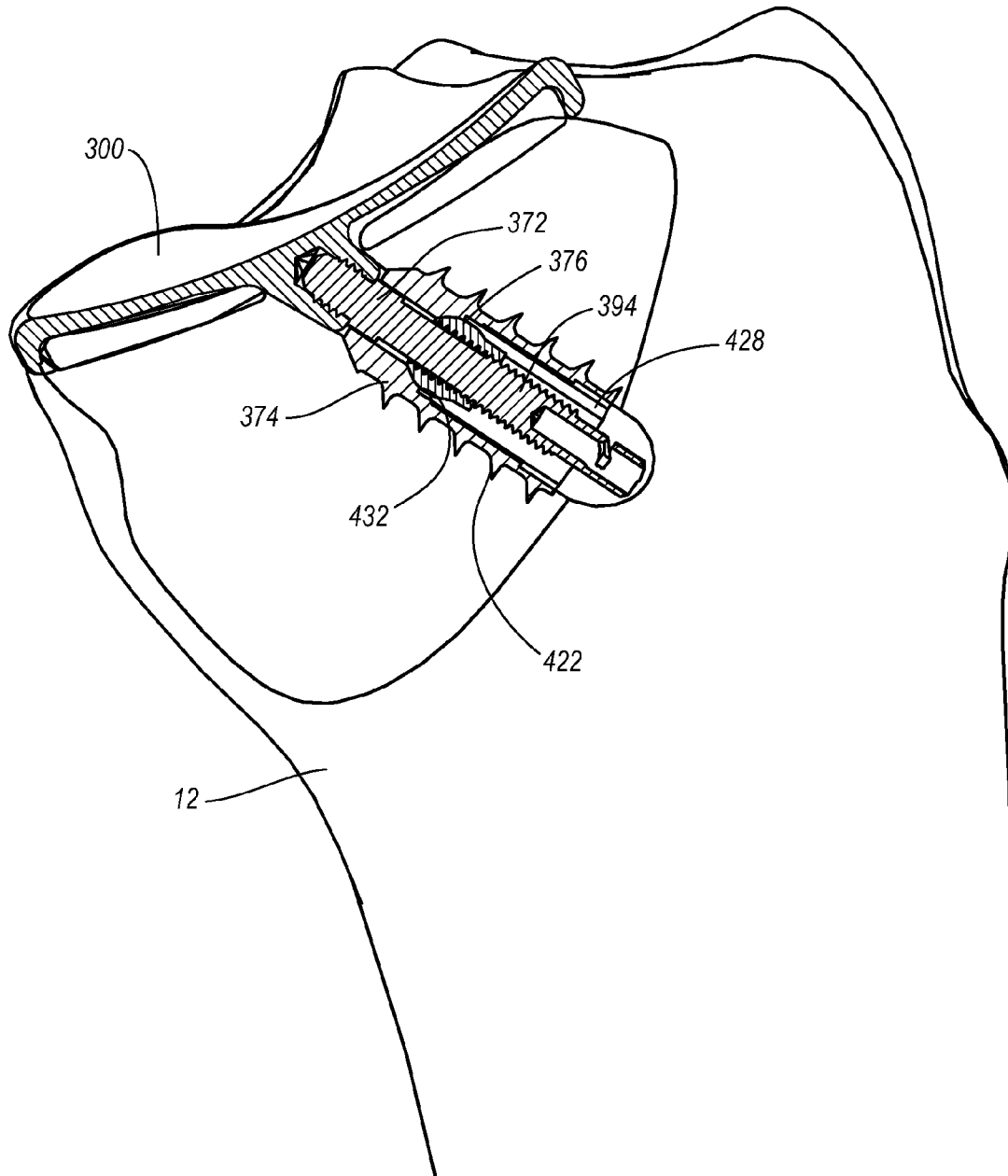
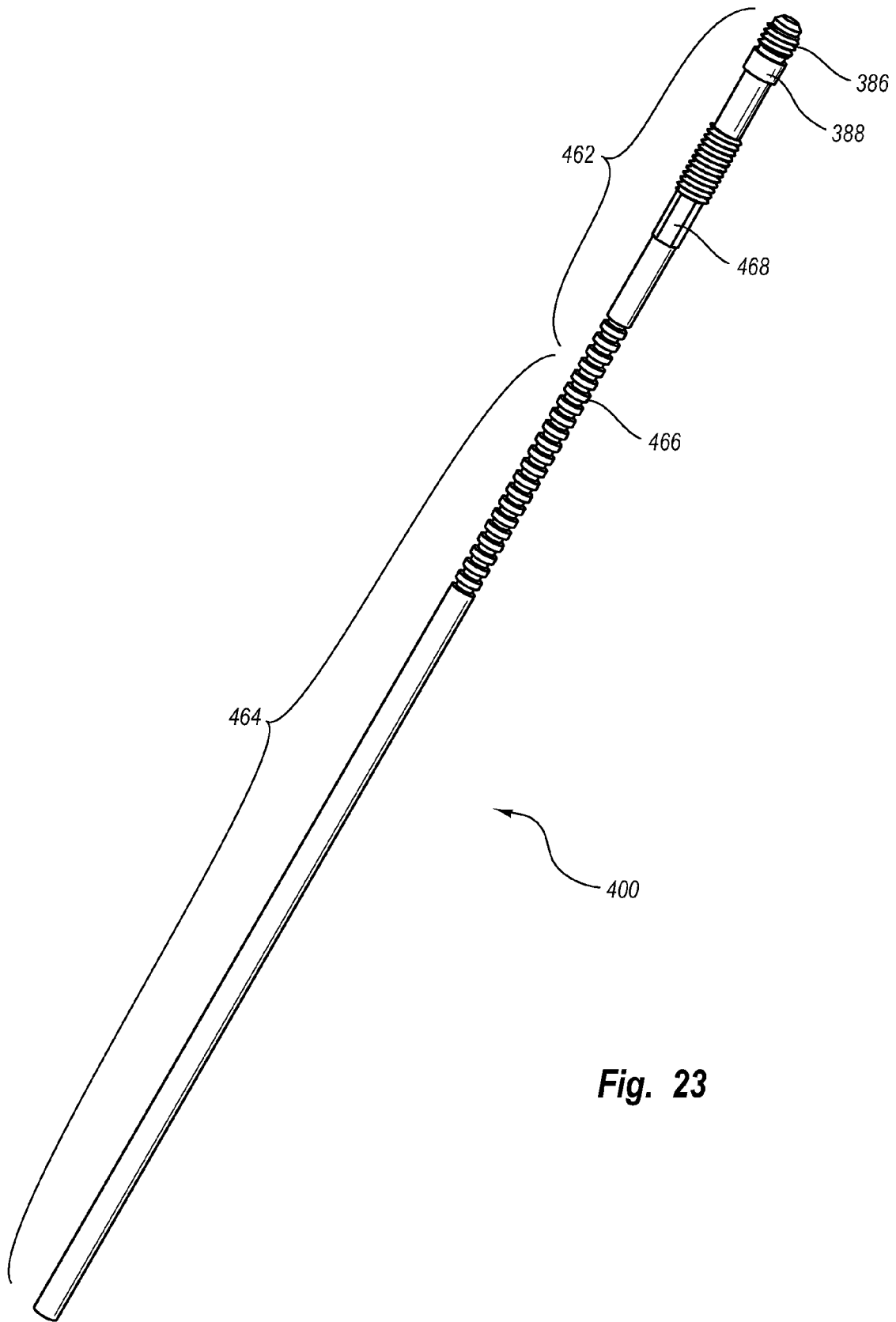

Fig. 22



**Fig. 23**

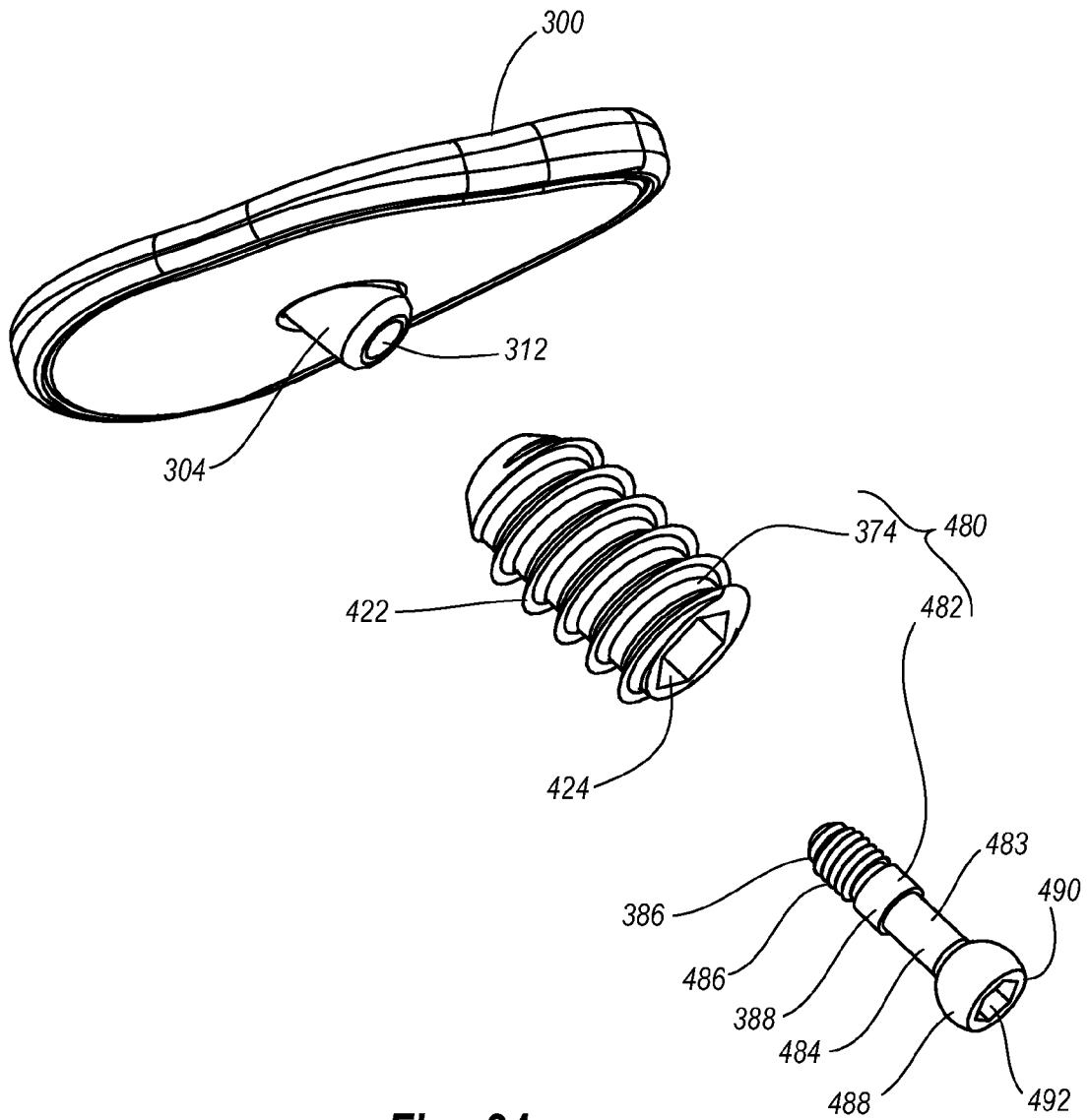

Fig. 24

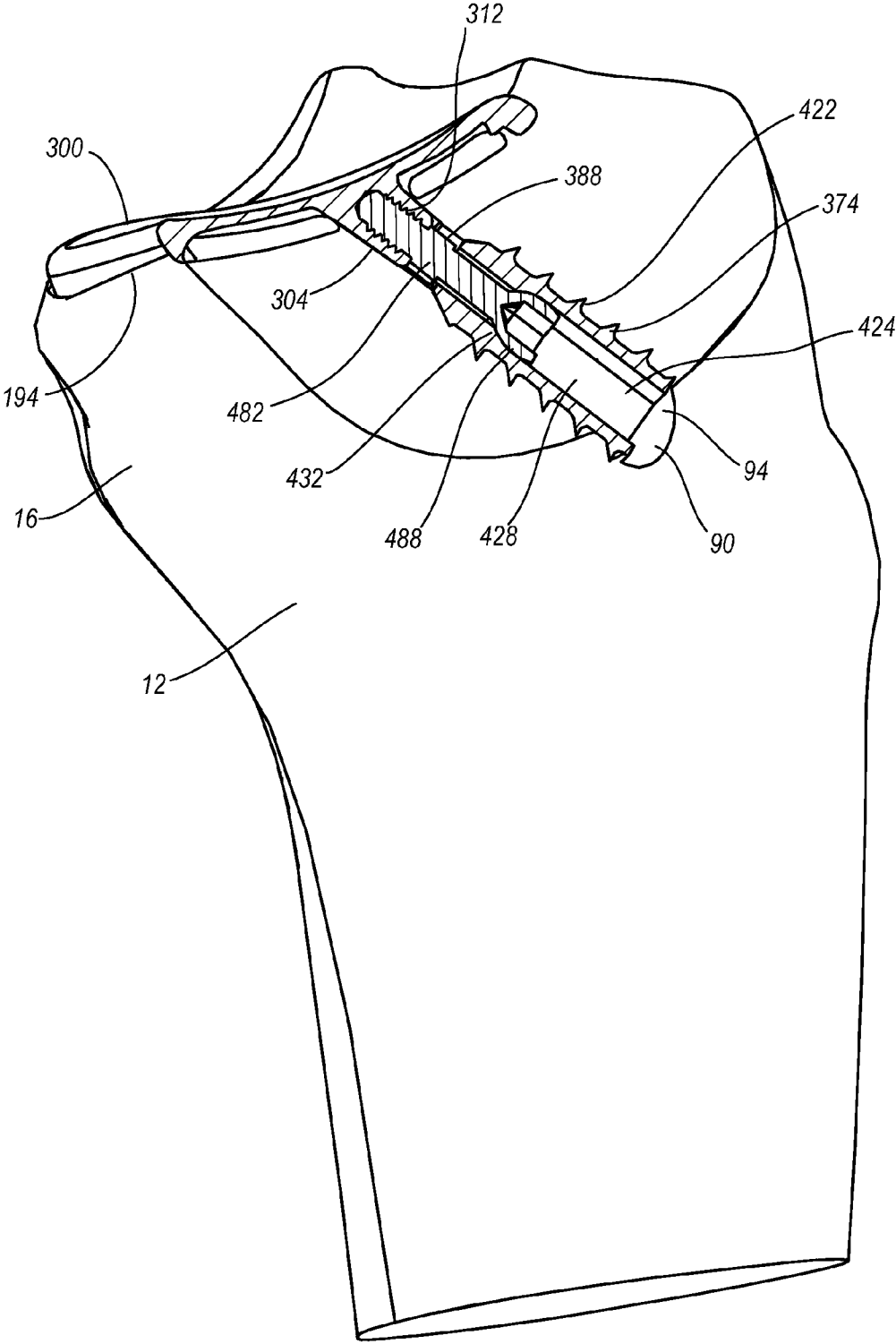

Fig. 25

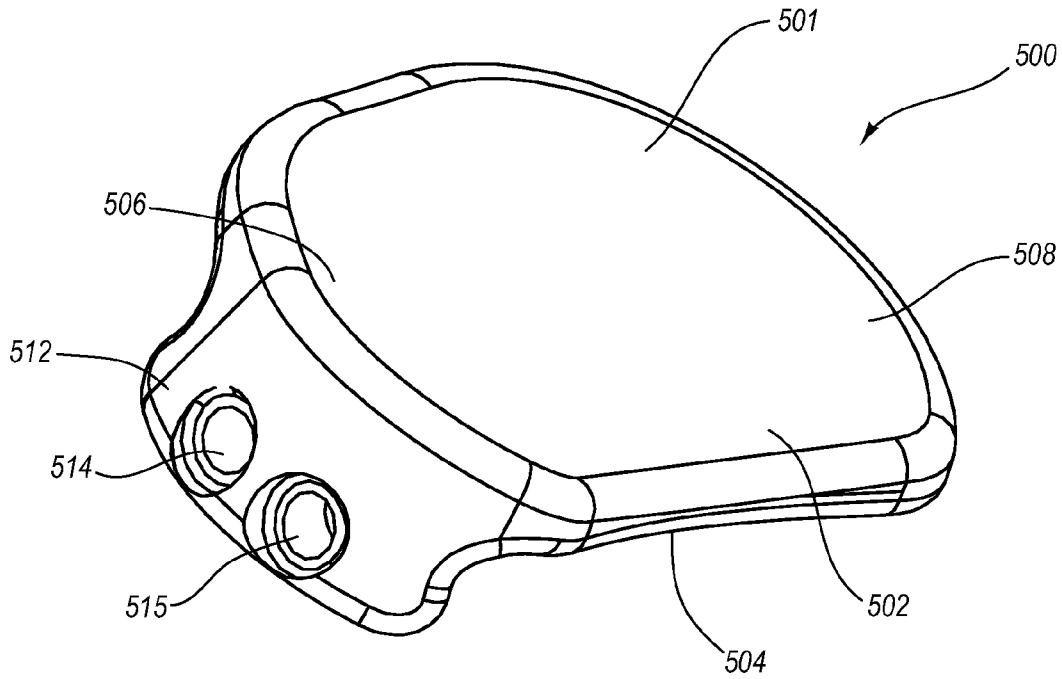

Fig. 26A

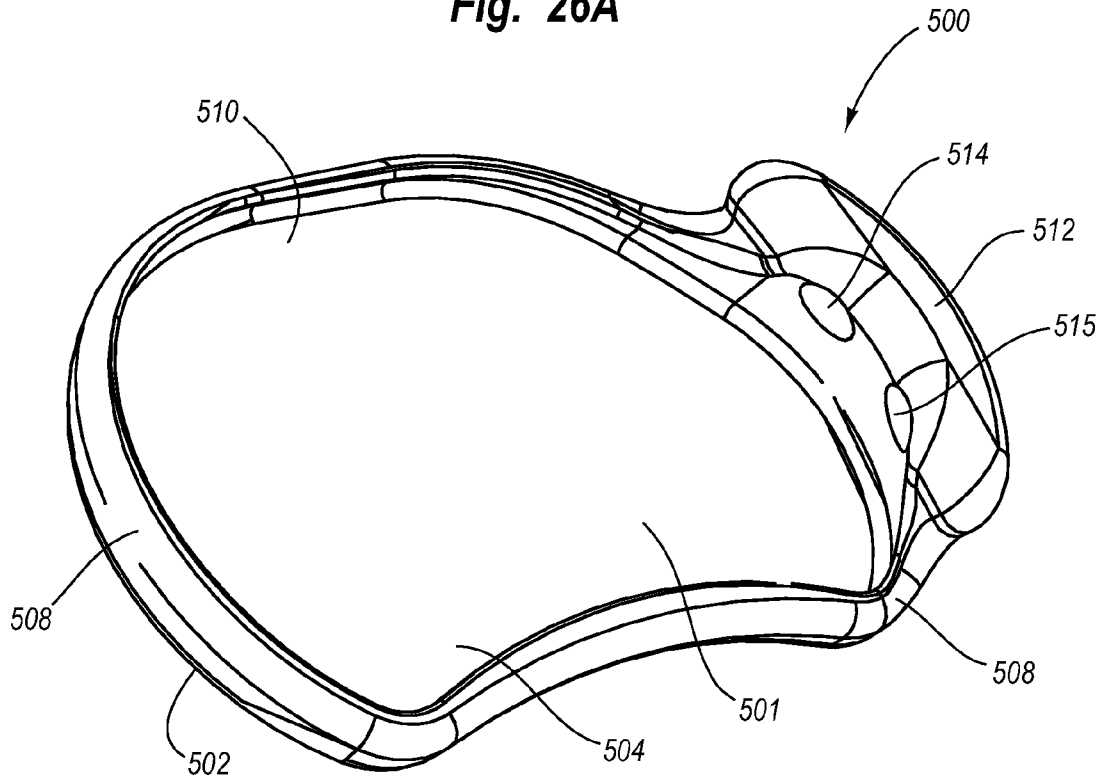
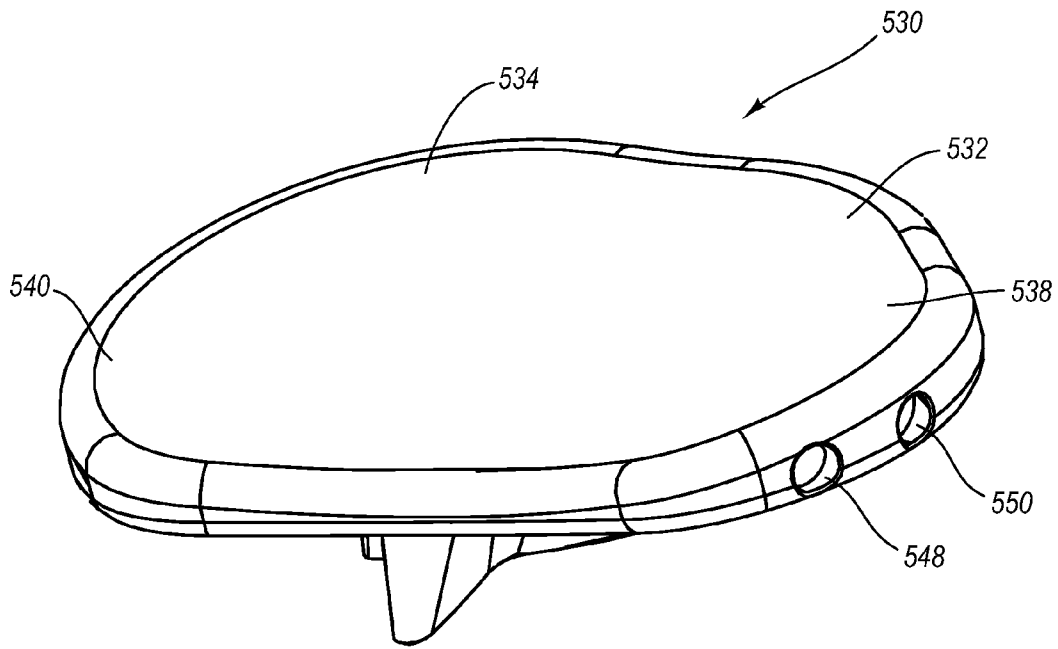
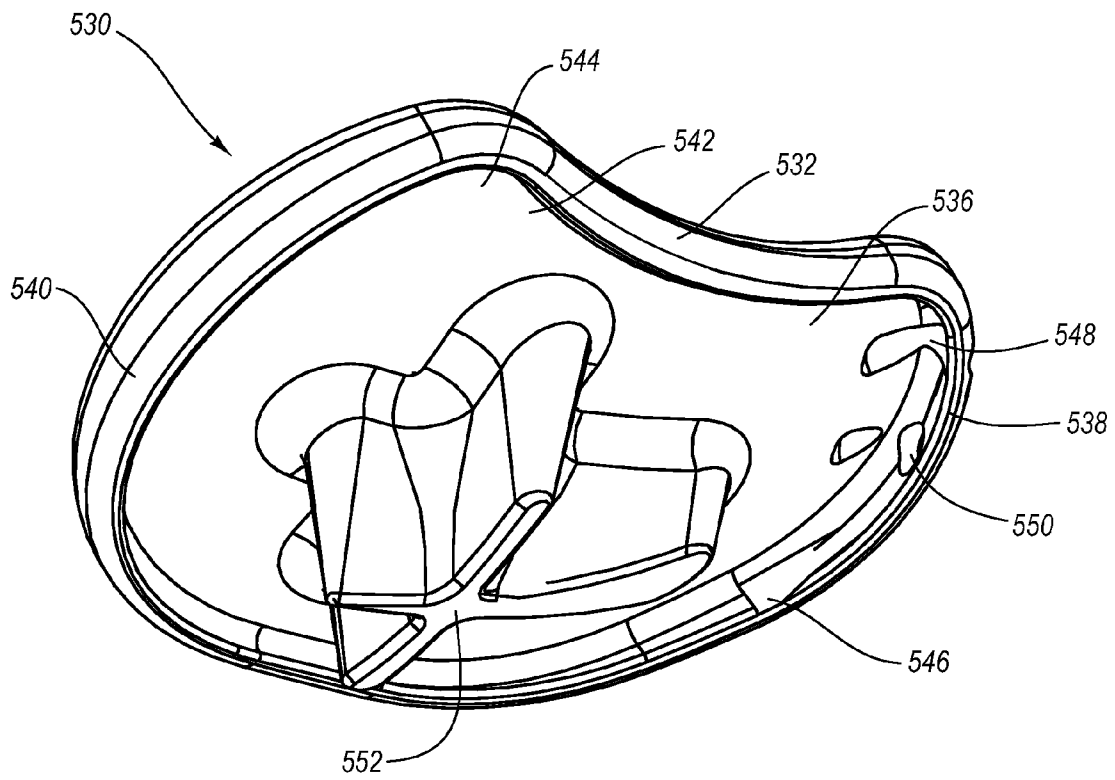

Fig. 26B



**Fig. 27A**



**Fig. 27B**

1

**TIBIAL CONDYLAR HEMIPLASTY  
IMPLANTS, ANCHOR ASSEMBLIES, AND  
RELATED METHODS**

CROSS-REFERENCE TO RELATED  
APPLICATIONS

Not applicable.

BACKGROUND OF THE INVENTION

1. The Field of the Invention

The present invention relates to tibial condylar hemiplasty implants, anchor assemblies used to secure such implants to the tibia, and the related methods.

2. The Relevant Technology

The knee joint comprises two generally rounded condyles, i.e., lateral and medial condyles, that are located at the lower or distal end of the femur. These femoral condyles are disposed above corresponding lateral and medial condyles located at the upper or proximal end of the tibia. A flexible meniscus provides cushioning between the opposing matching pairs of condyles.

As a result of injury, wear, disease or other causes, it is occasionally necessary to replace all or part of the knee joint. Knee replacements typically entail cutting off or resecting both of the femoral condyles and the tibial condyles. Complementary artificial implants are then mounted on the distal end of the femur and the proximal end of the tibia. Where only one condyle has been injured, more recent procedures provide for partial knee replacement. In this procedure, only one of the lateral or medial femoral condyles is resected. The corresponding one of the lateral or medial tibial condyles is also resected. Implants referred to as "unicondylar" implants are mounted on the resected area of the femur and tibia.

Although knee replacements have met with success, one of the significant drawbacks to knee replacements is the recovery. Traditional knee replacements, both full and partial, require an open procedure wherein relatively large incisions are made so as to fully expose the respective ends of the femur and tibia. This exposure is necessary when using conventional techniques to resect the femur and tibia and for mounting the implants. For example, conventional tibial implants are screwed directly into the resected end face of the tibia. Mounting such screws requires exposure of the resected end face. In yet other embodiments, projections are formed on the implants which are received within slots formed on the resected end face of the tibia. Again, forming of the slots and inserting the implant into the slots requires substantially full expose of the resected end face of the tibia.

In general, the more invasive the surgery, the more difficult and time consuming the patient recovery. Furthermore, such open and invasive surgeries have a greater risk of infection.

Accordingly, what is needed are systems and methods for resecting and mounting a condylar implant on the tibia that uses procedures that minimize incisions, the amount of bone resection, and/or the impact on soft tissue.

BRIEF DESCRIPTION OF THE DRAWINGS

Various embodiments of the present invention will now be discussed with reference to the appended drawings. It is appreciated that these drawings depict only typical embodiments of the invention and are therefore not to be considered limiting of its scope.

2

FIG. 1 is a perspective view of the proximal end of a tibia;

FIG. 2 is a perspective view of a guide assembly for forming a tunnel on the proximal end of the tibia shown in FIG. 1;

FIG. 2A is a perspective view of an alternative template used with the guide assembly shown in FIG. 2;

FIG. 3 is a perspective view showing the guide assembly in FIG. 2 mounted on the tibia of FIG. 1;

FIG. 4 is a perspective view of the tibia shown in FIG. 1 having a tunnel formed thereon;

FIG. 5 is a perspective view of a rasp assembly resecting the tibia of FIG. 4;

FIG. 6 is a top perspective view of the rasp assembly shown in FIG. 5;

FIG. 7 is a bottom perspective view of the rasp assembly shown in FIG. 6;

FIG. 8 is an exploded perspective view of the retention rod shown in FIG. 5;

FIGS. 9A and 9B are perspective views of the retention rod shown in FIG. 8 being mounted to the rasp assembly shown in FIG. 5;

FIG. 10 is a perspective view of the tibia shown in FIG. 4 having a recess formed thereon;

FIG. 11 is a perspective view of a cutting template being mounted on the tibia shown in FIG. 4;

FIG. 12A is a top perspective view of a condylar implant;

FIG. 12B is a bottom perspective view of the condylar implant shown in FIG. 12A;

FIG. 12C is an exploded perspective view of the condylar implant shown in FIG. 12B;

FIG. 13 is a perspective view of an alternative embodiment of a condylar implant;

FIG. 14 is a perspective view of another alternative embodiment of a condylar implant;

FIG. 15A is a top exploded perspective view of the condylar implant shown in FIG. 14;

FIG. 15B is bottom exploded perspective view of the condylar implant shown in FIG. 15A;

FIG. 16A is a top exploded perspective view of an alternative condylar implant;

FIG. 16B is bottom exploded perspective view of the condylar implant shown in FIG. 16A;

FIG. 17 is an exploded view of an anchor assembly for securing a condylar implant to the tibia shown in FIG. 10;

FIG. 18 is a side view of the fastener of the anchor assembly shown in FIG. 17 being secured to the condylar implant positioned on the tibia;

FIG. 19 is a cross sectional perspective view of the bone anchor of the anchor assembly shown in FIG. 17;

FIG. 20 is a side view of the bone anchor shown in FIG. 19 being FIG. 17 to the tibia shown in FIG. 18;

FIG. 21 is a side view of a crown nut of the anchor assembly shown in FIG. 17 being mounted to the fastener shown in FIG. 18;

FIG. 22 is a cross sectional side view of the assembled anchor assembly shown in FIG. 17 securing the condylar implant to the tibia;

FIG. 23 is a perspective view of an alternative embodiment of the fastener shown in FIG. 17;

FIG. 24 is an alternative embodiment of an anchor assembly;

FIG. 25 is a cross section side view of the anchor assembly shown in FIG. 24 securing a condylar implant to a tibia;

FIG. 26A is a top perspective view of an alternative embodiment of a condylar implant;

FIG. 26B is a bottom perspective view of the condylar implant shown in FIG. 26A;

FIG. 27A is a top perspective view of another alternative embodiment of a condylar implant; and

FIG. 27B is a bottom perspective view of the condylar implant shown in FIG. 7A.

#### DETAILED DESCRIPTION OF THE PREFERRED EMBODIMENTS

The present invention relates to methods and apparatus for preparing and mounting a condylar implant on a tibia of a patient. The methods and apparatus are designed so that the condylar implant can be mounted using procedures that are minimally invasive. As a result, recovery time is significantly improved while the risk of infection minimized.

Depicted in FIG. 1 is a proximal end 10 of a tibia 12. Proximal end 10 has a lateral side 14 and a medial side 16 which each extend between an anterior side 18 and a posterior side 19. Proximal end 10 further comprises a lateral condyle 20 and a medial condyle 21. Lateral condyle 20 terminates proximally at a lateral facet 22 of a superior articular surface of tibia 12 while medial condyle 21 terminates proximally at medial facet 24 of a superior articular surface of tibia 12.

Although tibia 12 shown in FIG. 1 is from a left leg, it is appreciated that the tibia of the right leg has a complimentary configuration and that the methods and apparatus disclosed herein are equally applicable thereto. Furthermore, the methods and apparatus disclosed herein are primarily illustrated in association with medial condyle 21 of tibia 12. It is also appreciated that the methods and apparatus can be used in association with lateral condyle 20.

In one embodiment, to facilitate mounting of a condylar implant on medial condyle 21, conventional arthroscopic procedures are used to resect the posterior portion of the medial meniscus. Once the posterior portion of the medial meniscus is removed, a vertical or horizontal incision, generally in a range between about 2 cm to about 6 cm, is formed over the anterior side of the medial meniscus. Following retraction of the surrounding tissue, the anterior side of the medial meniscus is resected. A coarse rasp is then inserted between the medial condyle of the femur and medial condyle 21 of tibia 12. The rasp is used to remove approximately 1-2 mm of articular cartilage on medial facet 24 of tibia 12. Removal of the meniscus and the articular cartilage provides increased access to medial facet 24 of tibia 12.

Depicted in FIG. 2 is one embodiment of a guide assembly 30 which is now used for forming a tunnel through a portion of tibia 12. As discussed below in greater detail, the tunnel can be used for preparing tibia 12 for a condylar implant and/or securing a condylar implant to tibia 12. In general, guide assembly 30 includes a substantially U-shaped guide brace 32 having a template 34 and a tubular guide sleeve 36 mounted on opposing ends thereof. More specifically, guide brace 32 has a first end 38 and an opposing second end 40. Recessed in first end 38 is a socket 42.

Template 34 comprises a low profile base plate 44 having a top surface 46 and an opposing bottom surface 48 which each extend between a first end 50 and an opposing second end 52. Although not required, in one embodiment bottom surface 48 has a configuration generally complementary to medial facet 24 of the superior articular surface of tibia 12. Base plate 44 typically has a maximum thickness extending between surfaces 46 and 48 in a range between about 1 mm to about 4 mm. Projecting from second 52 of base plate 44 is a stem 54. Stem 54 is configured to be slidably received within socket 42 of guide brace 32. A projection 56 downwardly extends from bottom surface 48 of base plate 44 at first end 50. As depicted,

projection 56 has the configuration of a narrow finger. In other embodiments, projection 56 can comprise an elongated ridge or other configurations.

Formed on second end 40 of guide brace 32 is an enlarged housing 60 having a passage 62 extending therethrough. A resiliently flexible clamp arm 64 is mounted to housing 60. An aperture 66 extends through clamp arm 64 in general alignment with passage 62.

Tubular guide sleeve 36 slidably extends through passage 62 and aperture 66. Guide sleeve 36 has a proximal end 68 and an opposing distal end 70. A plurality of sharpened teeth 72 are formed at distal end 70. By pressing clamp arm 64 toward housing 60, passage 62 and aperture 66 are aligned allowing guide sleeve 36 to freely slide within passage 62 and aperture 66 to a desired location. As clamp arm 56 is released, clamp arm 56 resiliently biases away from housing 60 so as to bind guide sleeve 36, thereby securing guide sleeve 36 in the desired location. In alternative embodiments, it is appreciated that clamp arm 64 can be replaced with a set screw, clamp, or a variety of other types of fasteners that can be used to selectively secure guide sleeve 36 to second end 40 of guide brace 32.

During use, as depicted in FIG. 3, template 34 is slid over medial facet 24 of tibia 12 so that projection finger 56 catches on posterior side 19 of tibia 12. Projection finger 56 thus facilitates proper positioning of template 34 and also, helps to retain template 34 on medial facet 24. It is appreciated that the size and shape of the lateral and medial facets of the superior articular surfaces of the tibia varies between different patients. As such, the present invention comprises a plurality of alternative templates 34 which are configured for placement on one of the lateral and medial facet and which each have a different configuration. As such a number of the alternative templates 34 can be initially test fitted to determine one that has a best fit for a particular patient.

For example, depicted in FIG. 2A is one alternative template 34A that is smaller than template 34. Like elements between templates 34 and 34A are identified by like reference characters. In further contrast to template 34, template 34A has a projection 56A downwardly extending from second end 52 of base plate 44. Projection 56A thus biases against anterior side 18 or medial side 16 of tibia 12 to help properly position template 34A. In yet other embodiments, in contrast to positioning the projection on one of the opposing ends of base plate 44, the projection can be positioned along one of the opposing sides of base plate 44 so as to bias against lateral side 14 (when used on lateral facet 22) or bias against medial side 16 of tibia 12.

Once template 34 is selected and properly positioned on medial facet 24, tubular guide sleeve 36 is advanced within housing 60 so that teeth 72 at distal end 70 bias against medial side 16 of proximal end 10 of tibia 12. Guide sleeve 36 is then secured in place by releasing clamp arm 64. By securing guide sleeve 36 against tibia 12, guide assembly 30 is clamped onto tibia 12. In one alternative embodiment, guide sleeve 36 can be biased against anterior side 18 of tibia 12.

Next, a tubular drill sleeve 76 is inserted into tubular guide sleeve 60. Positioned within drill sleeve 76 is a guide wire 78. Using drill sleeve 76 as a guide, guide wire 78 is drilled through tibia 12 until guide wire 78 reaches template 34, thereby forming a guide tunnel. In part, template 34 functions as a shield to prevent guide wire 78 and/or other drill tools from accidentally contacting and damaging the femur. In other embodiments, a hole or recess is formed on template 34. Guide wire 78 can be passed through or into the hole or recess to ensure complete formation of the tunnel on medial facet 24.

Once the guide tunnel is formed, guide wire **78** and drill sleeve **76** are removed from guide sleeve **60**. A larger drill tool, not shown, such as a larger guide wire, drill bit, or the like is then passed through guide sleeve **60** and drilled through tibia **12** along the guide tunnel to form a final tunnel **90** (FIG. **4**) through tibia **12**. It is appreciated that any number of progressively larger drill tools can be used. In alternative embodiments guide wire **78** and drill sleeve **76** can be eliminated. A single larger drill tool can then be used to form tunnel **90** in a single pass. Using a sequence of larger drill tools, however, helps ensure proper placement of tunnel **90** and facilitates forming the opening of the tunnel adjacent to template **34**.

As discussed below in greater detail, the angular orientation of tunnel **90** is typically held constant and is based on the configuration of the implant. However, depending on the amount of bone needed to be resected for mounting the condylar implant, it may be necessary to shift the position of tunnel **90** posterior or anterior. Shifting the position of tunnel **90** posterior-anterior is accomplished by selectively moving stem **54** of template **34** further into or further out of socket **42** of guide brace **32**. Once template **34** and guide brace **32** are positioned at their relative positions, a set screw **80** is tightened so as to secure template **34** and guide brace **32** together. Predefined markings **82** are formed on stem **54** to help define the relative positioning between template **34** and guide brace **32**.

Once tunnel **90** is formed, guide assembly **30** is removed so as to produce tibia **12** shown in FIG. **4**. As depicted, tunnel **90** has an interior surface **92** that extends from a proximal end **94** to an opposing end distal end **96**. Proximal end **94** is formed on medial side **16** of proximal end **10** of tibia **12**. Distal end **96** is formed on medial facet **24** of tibia **12**. Although tunnel **90** can be any desired size, in one embodiment tunnel **90** has a diameter in a range between about 5 mm to about 10 mm.

Using the above discussed methods and instruments, tunnel **90** is formed by procedures that are minimally invasive to the patient. As discussed below in greater detail, once tunnel **90** is formed, tunnel **90** can then be used to assist in the resection of medial fact **24** and/or the mounting of a condylar implant on the resected medial facet **24**. Furthermore, by using tunnel **90** the resection of medial facet **24** and the mounting of the condylar implant can also be performed using procedures that are minimally invasive.

Although not required, in one embodiment as mentioned above tunnel **90** is used in the resection of tibia **12** for preparing tibia **12** to receive a condylar implant. The resection of tibia **12** can be accomplished using a number of different procedures. For example, as depicted in FIG. **5**, is one embodiment of a rasp assembly **100** is used in association with a retention rod **102** to facilitate resection of tibia **12**.

As depicted in FIG. **6**, rasp assembly **100** comprises a rasp body **104** having a pivot arm **105** mounted thereon, a rasp guide **106**, and a cover plate **108**. More specifically, as depicted in FIGS. **6** and **7**, rasp body **104** has a top surface **110** and an opposing bottom surface **112** that each extend between a proximal end **114** and an opposing distal end **116**. Transversely extending across bottom surface **112** are a plurality of ridges **118** that each terminate at a sharpened cutting edge **120**. It is appreciated that ridges **188** and cutting edges **120** can be at any desired orientation or combination of different orientation that facilitate cutting. Bottom surface **112** is configured such that reciprocating movement of bottom surface **112** on tibia **12** produces a recess on tibia **12** that can receive a desired implant. Recessed on top surface **110** of rasp body **104** is a guide slot **122**. Guide slot **122** is bounded by a floor

**124** and a sidewall **126** upstanding from floor **124**. Extending through floor **124** to bottom surface **112** is an opening **128**.

Rasp guide **106** comprises a slide plate **130** having a top surface **131** and an opposing bottom surface **133**. Downwardly projecting from bottom surface **133** are a pair of spaced apart forks **132A** and **132B** with a pin **134** extending therebetween. Forks **132A** and **B** have facing interior surfaces **136** which bound a gap **137** and have opposing exterior surfaces **138**. Forks **132A** and **B** terminate at a free terminus **140**. Exterior surface **138** of each fork **132A** and **B** is recessed at terminus **140** such that a sloping shoulder **142** is formed on each fork **132A** and **B**.

Rasp guide **106** is received within guide slot **122** so that forks **132A** and **B** project through opening **128**. Rasp guide **106** is slightly smaller than guide slot **122** such that forks **132A** and **B** are free to reciprocate within opening **128** as slide plate **130** reciprocates within guide slot **122**. As shown in FIG. **5**, cover plate **108** is secured within guide slot **122** so as to retain rasp guide **106** within guide slot **122**. Cover plate **108** can be mounted using conventional techniques such as welding, press fit, and the like. Holes **144** are formed through cover plate **108** to prevent unwanted build-up of resected bone particles within guide slot **122**.

As depicted in FIG. **6**, pivot arm **105** has a proximal end **146** and an opposing distal end **148**. A set hole **149** extends through pivot arm **105** toward proximal end **146**. Distal end **148** of arm **105** is hingedly mounted to proximal end **114** of rasp body **104** by a pin **150**.

In one embodiment, an insertion handle **160** is used to place rasp body **104** over medial facet **24** of tibia **12**. Insertion handle **160** has a proximal end **162** and an opposing distal end **164**. A post **165** is formed a proximal end **162**. Post **165** is adapted to receive an extension handle if desired. A pair of spaced apart lips **166A** and **B** project from distal end **164** and bound a slot **163**. A channel **168** (FIG. **5**) longitudinally extends through insertion handle **160** so as to communicate with slot **163**. Channel **168** is configured to receive pivot arm **105** when rasp body **104** is received within slot **163**.

During use, pivot arm **105** is slid into channel **165** from between lips **166A** and **B**. Lips **166A** and **B** are then advanced to extend above and below proximal end **114** of rasp body **104**. A set screw **168** (FIG. **7**) is then advanced into insertion handle **160** so as to extend through set hole **149** on pivot arm **105**. In this configuration insertion handle **160** rigidly supports rasp body **104** so as to prevent hinged movement of rasp body **104** during insertion.

Turning to FIG. **8**, retention rod **102** comprises a tubular set rod **172** bounding a channel **174** extending from a proximal end **176** to an opposing distal end **178**. Distal end **178** terminates at a distal end face **179**. A handle **180** outwardly projects from proximal end **176** to facilitating grasping retention rod **102**.

Retention rod **102** further comprises a hook rod **182**. Hook rod **182** has a proximal end **184** and an opposing distal end **186**. Projecting from distal end **186** is a hook **188**. Threads **190** are formed on proximal end **184**. A knob **192** is also provided having a threaded port **193**. Threads **190** on hook rod **182** are configured to mate with threaded port **193** of knob **192**. Hook rod **182** is received within channel **174** of set rod **172** such that knob **192** biases against handle **180** and hook **188** extends beyond distal end face **179**. In this configuration, rotation of knob **192** relative to hook rod **182** causes hook **188** to extend or retract relative to set rod **172**.

During operation, as depicted in FIG. **5**, rasp assembly **100** is mounted on medial facet **24** of tibia **12**. Rasp assembly **100** is positioned using the rigidly mounted insertion handle **160**, as discussed above, such that forks **132A** and **B** (FIG. **7**) are

aligned with the distal end of tunnel 90. Once rasp assembly 100 is positioned, retention rod 102 is advanced within tunnel 90 from proximal end 94. As depicted in FIG. 9A, knob 192 is rotated so that hook 188 extends beyond set rod 172. With hook 188 freely exposed, hook 188 is hooked over pin 134 extending between forks 132A and B.

As depicted in FIG. 9B, once hook 188 has captured pin 134, knob 192 is rotated so as to advance set rod 172 toward hook 188. Set rod 172 is advanced until distal end face 179 of set rod 172 biases against shoulders 142 of forks 132A and B. Shoulders 142 are sloped such that end face 179 can sit flush against shoulder 142 while set rod 172 retains its orientation within tunnel 90. In this configuration, retention rod 102 is securely fixed to rasp guide 106.

Once retention rod 102 is secured to rasp assembly 100, insertion handle 160 is removed from pivot arm 105. A reciprocal driver, such as a reciprocal saw, not shown, is then connected pivot arm 105. While holding rasp guide 106 substantially stationary by holding onto retention rod 102, the reciprocal driver rapidly reciprocates rasp body 104 so that cutting edges 120 resect medial facet 24 of tibia 12. In one embodiment, rasp body 104 reciprocates along a length in a range between about 1 mm to about 4 mm. Other dimensions can also be used.

In one embodiment bottom surface 112 of rasp body 104 slightly arched. By having pivot arm 105 hingedly attached to rasp body 104, rasp body 104 is free to reciprocate along the arched path. The hinged attachment also helps to minimize binding of rasp body 104. In alternative embodiments, arm 105 can be rigidly attached to rasp body 104.

In one embodiment of the present invention means are provided for removably engaging retention rod 102 with rasp body 104 such that rasp body 104 can be selectively reciprocated without substantial movement of retention rod 102. By way of example and not by limitation, one embodiment of the means comprises rasp guide 106 slidably mounted on rasp body 104 and hook 188 mounted on retention rod 102. In alternative embodiments it is appreciated that a variety of different structures can accomplish the same function. For example, pin 134 and hook 188 can be replaced with a threaded connection, bayonet connection, or any number of other conventional connections which allows retention rod 102 to engage with rasp guide 106.

It is also appreciated that rasp guide 106 can be mounted on rasp body 104 in a variety of different ways. For example, opening 128 can extend through rasp body 104 without the formation of guide slot 122. In this embodiment slide plate 130 can be positioned directly on top surface 110 of rasp body 104 while forks 132A and B extend through opening 128. In yet another alternative, guide slot 122 can be formed on bottom surface 112 of rasp body 104. Cover plate 108 can be formed having opening 128 extending therethrough and cutting edges 120 formed on a bottom surface thereof. Slide plate 130 can be positioned within the guide slot 122 so that when cover plate 108 is secured over guide slot 122, forks 132A and B extend through opening 128 formed on cover plate 108.

It is also appreciated that retention rod 102 can have a variety of different configurations. For example, in alternative embodiments set rod 172 can be eliminated. As such, retention rod 102 can simply comprise hook rod 182. Furthermore, as discussed above, hook 188 can be replaced with a variety of different types of connectors.

Once medial facet 24 has been sufficiently resected by rasp body 104, rasp assembly 100 and retention rod 102 are removed. The resected bone particles are removed by conventional flushing and suction. As depicted in FIG. 10, tibia 12 now has a resected recess 194 formed on medial facet 24.

It is appreciated that the resection of tibia 12 can be accomplished using a variety of different techniques. For example, in one alternative depicted in FIG. 11, the resection of tibia 12 is accomplished by cutting through an area bounded by a cutting template 200. Cutting template 200 comprises a plate 202 having a top surface 204 and an opposing bottom surface 206. In the embodiment depicted cutting template 200 is configured to rest on lateral facet 22 of tibia 12. Of course, cutting template 200 can also be designed for resting on medial facet 24.

Extending between opposing surfaces 204 and 206 are a plurality of guide spaces 208. Guide spaces 208 are formed so that when cutting template 200 is positioned, guide spaces 208 are positioned over at least a portion of the facet to be resected. In the embodiment depicted, guide spaces 208 have the configuration of an elongated channel. As will be discussed below in greater detail, the channels facilitate guided receipt of a cutting burr 210 which is used to selectively remove the unwanted bone. In alternative embodiments, depending on the type and size of tool used to remove the bone, guide spaces 208 can come in a variety of different sizes, shapes, and orientations.

In one embodiment, although not required or shown, a second cutting template is provided having guide spaces extending therethrough. In the second cutting template, the guide spaces are aligned so as to bound the area of the facet to be resected which was blocked by plate 202 of cutting template 200. As a result, by sequentially using both cutting templates, all or at least a greater proportion of the bone can be removed by cutting burr 210. Additional cutting templates can also be used.

Cutting template 200 is used in association with retention rod 102 as previously discussed. In the embodiment depicted, handle 180 has a different configuration. During use, cutting template 200 is positioned over lateral facet 22. Distal end 178 of set rod 172 is advanced through tunnel 90 so that hook 188 of hook rod 182 projects out of set rod 172. Hook 188 is passed through a guide space 208 and then pulled back onto top surface 204 of plate 202. A rib 212 upwardly projects from plate 202 adjacent to guide space 208. Hook 188 is hooked over rib 212 so as to improve the engagement between hook 188 and cutting template 200.

Once hook 188 is engaged to cutting template 200, knob 192 is rotated so as to bias set rod 172 against bottom surface 206 of template 200. As a result, retention rod 102 is securely clamped to cutting template 200. Accordingly, by pulling retention rod 102, cutting template 200 is securely held in place on lateral facet 22. Cutting burr 210 or some other form of drill bit is then advanced into and along each of guide spaces 208 so as to resect the portion of the bone directly below guide space 208. As previously discussed, in one embodiment cutting template 200 can be removed and replaced with a second template. Burr 210 can then be passed through guide spaces of the second template to remove further bone that was covered by cutting template 200.

In other alternatives, it is appreciated that once cutting template 200 is removed, the remaining bone portion can be removed by sight and feel without the use of a template. In yet other embodiments, depending on the type and amount of bone needed to be resected, a single template can be rotated or shifted on lateral facet 22 so that the single template is used to remove the desired bone.

In one embodiment of the present invention, means are provided for removably engaging retention rod 102 to cutting template 200 so that retention rod 102 secures cutting template 200 to the lateral or medial facet of tibia 12 when retention rod 102 is received within tunnel 90 of tibia 12. By

way of example and not by limitation, one embodiment of such means comprises hook **188** and guide space **208** which enables hook **188** to engage with cutting template **200**.

The present invention also envisions that there are a variety of other structures that can accomplish the same function. For example, the same structures and techniques as discussed above for securing retention rod **102** to rasp assembly **100** can also be used with cutting template **200**. That is, in one alternative forks **132A** and **B** with pin **134** can be mounted on bottom surface **206** of plate **202**. Other connections such as threaded connection, bayonet connections, and the like can also be used.

By using the above discussed instruments and methods, the lateral and medial facets of tibia **12** can be selectively resected by procedures that are minimally invasive.

Depicted in FIGS. **12A-12C** is one embodiment of a condylar implant **300** incorporating features of the present invention. The term "condylar implant" is broadly intended to include implants that can replace all or a portion of a condyle of a tibia. Accordingly, while the depicted embodiments show one conventional size and configuration for a condylar implant, in alternative embodiments the condylar implant can be larger to replace more of the tibia or can be smaller to replace only a section of a condyle of a tibia. In such alternatives, the condylar implant can have a variety of different configurations.

Condylar implant **300** comprises a bearing plate **302** having a stem **304** projecting therefrom and an inlay **320**. More specifically, bearing plate **302** comprises a top articular surface **306** and an opposing bottom surface **308**. In one embodiment, top articular surface **306** is contoured to mate with a corresponding femoral condyle.

A pocket **316** is recess on bottom surface **308**. Pocket **316** is bounded by a floor **317** and a sidewall **318** upstanding around the perimeter thereof. Stem **304** projects from bottom surface **308** and terminates at a distal terminus **310**. Recessed within distal terminus is a threaded socket **312**. Bearing plate **302** and stem **304** are typically comprised of a metal such as chromium, cobalt, titanium, or the like and alloys thereof but can also be made of ceramics or plastics. Bearing plate **302** and/or stem **304** can also be comprised of layers or sections of different materials. In one embodiment, bearing plate **302** has a maximum thickness typically in a range between about 2 mm to about 10 mm. Other dimensions can also be used depending on the amount that the tibial condyle is resected or worn away.

In one embodiment of the present invention, means are provided for connecting a fastener to stem **304**. One example of such means comprises threaded socket **312** as discussed above. In alternative embodiments, the threads within the socket on stem **304** could be replaced with bayonet slots, bayonet posts, ribs which are configured to mate with barbs or other forms of connectors. The socket can also be filled with an adhesive. In still other embodiments, the socket can be eliminated and threads, bayonet posts, barbs or other forms of connections can be formed on the exterior of stem **304**.

Secured within pocket **316** so as to encircle stem **304** is inlay **320**. Inlay **320** is comprised of a porous bone ingrowth material such as porous tantalum. Other conventional porous bone ingrowth materials can also be used. Inlay **320** is secured within pocket **316** using conventional techniques such as press fit, welding, adhesive, and the like. Inlay **322** has an exposed bottom surface **322** that can be substantially flat, arched, or can have any other desired configuration.

Centrally extending through stem **304** is a central longitudinal axis **314**. In one embodiment, stem **304** projects from floor **317** so as to form an angle  $\theta$  between central longitudinal

axis **314** and inlay **320** in a range between about 30° to about 60°. Other angles can also be used. Stem **304** typically has a length in a range between about 2 mm to about 10 mm. Other dimensions can also be used.

It is appreciated that condylar implant **300** can have a variety of alternative configurations. For example, stem **304** is primarily formed to provide sufficient room for socket **312** when bearing plate **302** has a relative small thickness. As the thickness of bearing plate **302** increases, stem **304** can be increasingly shortened as more of socket **312** can be formed directly into bearing plate **302**. As such, in some embodiments stem **304** can be eliminated in that all of socket **312** can be formed directly on bearing plate **302**.

Furthermore, in the depicted condylar implant **300**, pocket **316** is formed to receive inlay **320**. In alternative embodiments pocket **316** can be eliminated and a section of the porous bone ingrowth material can be mounted on the bottom surface of bearing plate **302** using other conventional fastening techniques such as adhesives, screws, alternative press fits, and the like. Furthermore, in contrast to one pocket **316**, a plurality of spaced apart pockets can be formed on bottom surface **308** with each pocket receiving a separate inlay **320**. Here it is noted that spikes, fins, or other forms of projections can also be formed projecting from bottom surface **308** of bearing plate **302**. These projections can penetrate into the tibia or be received within slots formed on the tibia to help prevent movement of bearing plate **302**.

In still other embodiments, it is appreciated that inlay **320** or other forms of the porous bone ingrowth material can be eliminated. In this embodiment, the condylar implant can comprise a single integral or monolithic member. For example, depicted in FIG. **13** is an alternative embodiment of a condylar implant **300A**. Implant **300A** is formed as a single integral member having top surface **306** and bottom surface **308**. Because of the increased thickness of implant **300A**, stem **304** is eliminated. Threaded socket **312** is formed directly on bottom surface **308**. Projections **309** extend from bottom surface **308**.

In yet another alternative embodiment, depicted in FIG. **14** is a condylar implant **326**. Like elements between condylar implants **300** and **326** are identified by like reference characters. In contrast to condylar implant **300** which is fixed and rigid, condylar implant **326** is mobile. Specifically, condylar implant **326** comprises a lower bearing plate **328** from which stem **304** projects and an upper bearing plate **330** that is slidably mounted on lower bearing plate **328**.

As depicted in FIGS. **15A** and **B**, lower bearing plate **328** has a top surface **332** and an opposing bottom surface **334** with a perimeter edge **335** extending therebetween. Pocket **316** is formed on bottom surface **334** to receive inlay **320**. Top surface **332** is substantially flat or inwardly arched and extends between an anterior end **336** and a posterior end **338**. A track **340** is recessed on top surface **332**. Track **340** has an open mouth extending through perimeter edge **335** at anterior end **336** and longitudinally extends toward posterior end **338**. Track **340** is bounded by a substantially flat floor **343** having a sidewall **344** upstanding therefrom. Sidewall **344** comprises a recess groove **345** which extends along floor **343** and an outwardly projecting lip **346** which projects along top surface **332**. As such, the opposing sidewalls **344** of track **340** form a mortis.

Upper bearing plate **330** comprises top articular surface **306** and a bottom surface **348** which each extend between an anterior end **350** and an opposing posterior end **352**. Bottom surface **348** has a configuration substantially congruent to top surface **332** of lower bearing plate **328**. Projecting from bottom surface **348** is an elongated key **354** which extends from

toward anterior end **350** to toward posterior end **352**. Key **354** has a sidewall **356** that is substantially complementary to sidewall **344** of tack **340** such that key **354** forms a tenon that can slide into track **340** from mouth **342**. In this position key **354** can freely slide along track **340** but is prevented from vertically separating from track **340**.

During use, upper bearing plate **330** can slide posterior-anterior on lower bearing plate **328** as the femoral condyle rotates on top articular surface **306**. This ability of upper bearing plate **330** to slide minimizes high stress points between the femoral condyle and upper bearing plate, thereby minimizing wear. Furthermore, because bearing plates **328** and **330** slide against each other on congruent surfaces, both of bearing plates **328** and **330** can be comprised of metal without producing undue wear. In other embodiments, bearing plates **328** and **330** can be comprised of plastics, ceramics, or composites of different materials. In addition, bearing plates **328** and **330** can be made of the same or different materials.

Although key **354** and track **340** are shown as being linear, in alternative embodiments they can be congruently curved to more naturally correspond to the bending movement of the knee. For example, depicted in FIGS. **16A** and **B** is another alternative embodiment of a condylar implant **360** which includes an upper bearing plate **361** and a lower bearing plate **362**. In this embodiment, lower bearing plate **362** includes a track **363** that is curved along the length thereof. Upper bearing plate **361** includes an elongated key **364** having a curve complementary to track **363** such that key **364** can freely slide within track **363**. As previously discussed, key **364** and track **363** can also be arched or curved in a vertical plane.

The present invention also provides means for connecting a fastener to the bottom surface of the bearing plate of a condylar implant. Examples of such means include stem **304** with threaded socket **312** or the other alternatives to threaded socket **312** as discussed above. Other examples of such means comprise the formation of threaded socket **312** directly on a bearing plate as depicted in FIG. **13**. In other alternatives, the threads of socket **312** can be replaced with barbs, bayonet connectors, adhesive, or other alternative forms of connectors.

Depicted in FIG. **17** is one embodiment of an anchor assembly **370** used to secure condylar implant **300** to tibia **12**. Anchor assembly **370** comprises a fastener **372**, a bone anchor **374**, and a crown nut **376**. Fastener **372** comprises an elongated shaft **380** having an exterior surface **381** extending between a proximal end **382** and an opposing distal end **384**. In one embodiment, fastener **372** has a length greater than 8 mm and more commonly greater 15 mm. Other dimensions can also be used.

Formed at distal end **384** of shaft **380** are threads **386** that are configured to threadedly mate with threaded socket **312** of stem **304**. Outwardly projecting proximal of threads **386** is an annular flange **388** which functions as a stop when fastener **372** is threaded into stem **304**. Recessed into proximal end **382** is a socket **390**. A pair of opposing bayonet slots **392** longitudinally extend through the sidewall bounding socket **390**. Finally, encircling and radially outwardly projecting from exterior surface **381** between proximal end **382** and flange **388** are engagement threads **394**.

As depicted in FIG. **18**, condylar implant **300** is mounted within recess **194** such that stem **304** is received within distal end **96** of tunnel **90**. A fastener driver **400** has a distal head **402** (FIG. **17**) that is configured to be received within socket **390** of fastener **372**. A pair of opposing bayonet prongs **404** project from head **402** and are configured to mate within bayonet slots **392**. With fastener driver **400** secured to prox-

mal end **382** of fastener **372**, fastener driver **400** is used to advance distal end **384** into tunnel **90** through proximal end **94**. Fastener **372** is advanced through tunnel **90** so that threads **386** are received within socket **312** of stem **304**. Fastener driver **400** is then rotated so that fastener **372** is threaded into stem **304**.

Next, bone anchor **374** is secured within tunnel **90**. In one embodiment, a tap, not shown, is used to initially thread interior surface **92** of tunnel **90**. This can be accomplished before or after positioning of fastener **372**. Alternatively, bone anchor **374** can be self-tapping.

As depicted in FIG. **17**, bone anchor **374** comprises a tubular body **410** having a substantially cylindrical configuration. Body **410** includes an interior surface **412** and an exterior surface **414** that each extend between a proximal end **416** and an opposing distal end **418**. Distal end **418** includes a tapered nose **420**. Encircling and radially outwardly projecting from exterior surface **414** are one or more helical threads **422**. As mentioned above, the threads can be conventional or self-taping. In alternative embodiments, threads **422** can be replaced by ridges, barbs, or other bone engaging structures used in conventional bone anchors. Bone anchor **374** can be formed of a biocompatible metal, a bioabsorbable polymer, a bioactive ceramic, or any other desired material.

As depicted in FIG. **19**, interior surface **412** bounds a channel **424** longitudinally extending through bone anchor **374**. Interior surface **412** comprises a first sidewall **426** extending from proximal end **416**, a second sidewall **430** extending from distal end **418**, and an annular shoulder **432** extending between first sidewall **426** and second sidewall **430**. First sidewall **426** has a maximum diameter that is greater than the maximum diameter of second sidewall **430**. As such, shoulder **432** is tapered so as to constrict from first sidewall **426** to second sidewall **430**. First sidewall **426** bounds a socket **430** which is configured to receive a tool for rotation of bone anchor **374**. As such, first sidewall **426** has a non-circular transverse cross section. In typical embodiments, first sidewall **426** has a polygonal transverse cross section.

Turning to FIG. **20**, a distal end **435** of a tubular anchor driver **436** is received within engagement socket **438** of bone anchor **374**. Distal end **435** has a polygonal configuration complementary to socket **438** such that rotation of anchor driver **436** rotates bone anchor **374**. Bone anchor **374** and anchor driver **436** are passed over the proximal end of fastener driver **400** and advanced to proximal end **94** of tunnel **90**. By rotating anchor driver **436**, bone anchor **374** is screwed into tunnel **90** using fastener driver **400** as a guide. Bone anchor **374** is sized so that threads **422** engage with interior surface **92** of tunnel **90**, thereby securing bone anchor **374** to tibia **12** within tunnel **90**. Bone anchor **374** is advanced so that bone anchor **374** encircles engagement threads **394** of fastener **372**. Using fastener driver **400** as a guide for bone anchor **374** helps to concentrically dispose bone anchor **374** around fastener **372**.

Once bone anchor **374** is positioned, anchor driver **436** is removed and crown nut **376** is positioned. As depicted in FIG. **17**, crown nut **376** comprises a rounded head **440** having a threaded bore **442** extending therethrough. Projecting from head **440** are a plurality of spaced apart prongs **444** having notches **446** formed therebetween. Crown nut **376** is configured to mate with a nut driver **450**. Nut driver **450** comprises a tubular shaft **452** that terminates at a distal end **454**. Projecting from distal end **454** are a plurality of spaced apart prongs **456**. Prongs **456** are configured to mate with crown nut

376 by being received within notches 446. In this mated configuration, rotation of nut driver 450 facilitates rotation of crown nut 376.

Turning to FIG. 21, with crown nut 376 mounted on nut driver 450, crown nut 376 and nut driver 450 are passed over the proximal end of fastener driver 400. Nut driver 450 is used to advance crown nut along fastener driver 400, into tunnel 90, and over fastener 372. Threaded bore 442 of crown nut 376 is configured to threadedly mate with engagement threads 394 on fastener 372. Accordingly, once crown nut 376 is advanced over fastener 372 to engagement threads 394, nut driver 450 is rotated causing crown nut 376 to threadedly engage with engagement threads 394.

As depicted in FIG. 22, socket 428 of bone anchor 374 is larger than head 440 of crown nut 376 such that crown nut 376 can freely pass therethrough. Shoulder 432, however, constricts to a diameter smaller than the diameter of head 440 of crown nut 376. Accordingly, crown nut 376 is advanced along fastener 372 by engaging with threads 394 until head 440 of crown nut 376 biases against shoulder 432 of bone anchor 374. Tightening crown nut 376 against shoulder 432 produces tension on fastener 376 which tightly secures condylar implant 300 against tibia 12.

In one embodiment, engagement threads 394 on fastener 372 rotate in a direction opposite threads 422 on bone anchor 374. For example, engagement threads 394 can be right-hand threads while threads 422 are left-hand threads. As a result, rotation of crown nut 376 against bone anchor 374 does not cause bone anchor 364 to rotate concurrently. Furthermore, once crown nut 376 is initially positioned, nut driver 450 is removed. Anchor driver 436 can then be repositioned over fastener driver 400 so as to engage with bone anchor 374. Anchor driver 436 can then be used to back bone anchor 374 a distance back toward proximal end 94 of tunnel 90. In so doing, fastener 372 is further tensioned so as to increase the force securing condylar implant 300 on tibia 12. Again, because threads 394 and threads 422 rotate in opposite directions, backing bone anchor 374 does not cause crown nut 376 to unscrew.

Finally, once crown nut 376 and bone anchor 374 are positioned in their final state, fastener driver 400 is removed from fastener 372. Closing procedures for the tissue are then performed.

As discussed above, fastener driver 400 is useful as a guide in directing placement of bone anchor 374 and crown nut 376. In contrast to being separately connected to fastener 372, in one alternative embodiment the fastener driver can be integrally formed with fastener 372. For example, depicted in FIG. 23 is a fastener system 460. Fastener system 460 includes a fastener 462 and an elongated drive rod 464 integrally formed with fastener 462. Like elements between fasteners 372 and 462 are identified by like reference characters. As with fastener 372, fastener 462 includes flange 388 and threads 386 and 394. Formed proximal of threads 394 is a mating region 468. Mating region has a polygonal or other non-circular transverse cross section. As such removal or further tightening of fastener 462 can be accomplished by passing a tubular driver over fastener 462 so as to engage with mating region 468.

In contrast to socket 390 of fastener 372, fastener 462 is integrally formed with drive rod 464. To facilitate separation of drive rod 464 from fastener 462, a plurality of annular breaking grooves 466 encircle fastener system 460 at spaced apart locations along the junction between fastener 462 and drive rod 464.

Fastener system 460 is used in substantially the same manner as fastener 372 and fastener driver 400. However, once

bone anchor 374 and crown nut 376 are finally positioned, fastener 462 and drive rod 464 are separated by breaking fastener system 460 at an annular breaking grooves 466 located adjacent to proximal end 94 of tunnel 90.

It is appreciated that the anchor assembly for condylar implant 300 can have a variety of different configurations. For example, depicted in FIG. 24 is an alternative embodiment of an anchor assembly 480. Anchor assembly 480 includes bone anchor 374, as discussed above, and a fastener 482. Like elements between fasteners 372 and 482 are identified by like reference characters. Fastener 482 includes a shaft 483 having a proximal end 484 and an opposing distal end 486. Mounted at or toward distal end 486 are threads 386 and flange 388 as discussed above. Mounted at proximal end 484 is an enlarged rounded head 488 that terminates at an end face 490. Recessed within end face 490 is a socket having a polygonal or other non-circular configuration. It is noted that head 488 has a maximum diameter that is smaller than the diameter of socket 424 of bone anchor 374 but larger than the minimum diameter of shoulder 432 of bone anchor 374. As such, head 488 seats against shoulder 432 when passed through bone anchor 374.

Turning to FIG. 25, in contrast to anchor assembly 370 where fastener 372 is initially positioned, in anchor assembly 480 bone anchor 374 is initially secured within tunnel 90 using anchor driver 436. Again, tunnel 90 can be pre-tapped or threads 422 on bone anchor 374 can be self-tapping. Once bone anchor 374 is positioned, a driver, not shown, is inserted within socket 492 of fastener 482. The driver is then used to advance distal end 486 of fastener 482 into tunnel 90, through channel 424 of bone anchor 374, and into socket 312 of condylar implant 300. The driver is then used to rotate fastener 482 so that threads 386 threadedly engage with socket 312. Fastener 482 is advanced into socket 312 until flange 388 contacts the end face of stem 304. The driver for fastener 482 is then removed.

Next, anchor driver 436 is inserted back into socket 428 of bone anchor 374. This can be accomplished by passing anchor driver 436 over the driver for fastener 482 or by first removing the driver for fastener 482. Anchor driver 436 is then used to back bone anchor 374 a distance toward proximal end 94 of tunnel 90. In so doing, shoulder 432 of bone anchor 374 biases against head 488 of fastener 482, thereby tensioning fastener 482 so as to securely bias condylar implant 300 against tibia 12. It is appreciated that threads 386 of fastener 482 and threads 422 of bone anchor 374 rotate in opposite directions so that the backing of bone anchor 374 does not unscrew fastener 482 from condylar implant 300.

It is appreciated that in alternative embodiments the various threaded connections used in association with the anchor assemblies can be replaced with bayonet connections, expanding collets, press fit barb connections, and other conventional connections commonly used in place of thread connections.

By using the above discussed condylar implants and anchor assemblies with the corresponding methods, it is appreciated that the condylar implants can be securely mounted to tibia 12 using procedures that are minimally invasive.

In other alternative embodiments, it is also appreciated that various condylar implants can be designed for implanting in a minimally invasive procedure which may or may not require the formation of a tunnel through tibia 12. For example depicted in FIGS. 26A and B is an alternative embodiment of a condylar implant 500 incorporating features of the present invention. Condylar implant 500 comprises a bearing plate 501 having a top articular surface 502 and an opposing bot-

15

tom surface **504** which each extend between an anterior end **506** and a posterior end **508**. Although not required, in the embodiment depicted, a pocket **510** is formed on bottom surface **504** to receive an inlay of bone ingrowth material (not shown).

Downwardly extending from bottom surface **504** at anterior end **506** is a mounting flange **512**. A pair of spaced apart holes **514** and **515** extend through mounting flange **512**.

During use, medial facet **24** is resected so as to receive condylar implant **500**. The resection can be preformed at least in part using the procedures as discussed above by forming tunnel **90**. Alternatively, other conventional techniques can be used to resect medial facet **24** without the formation of tunnel **90**. In either embodiment, a portion of the medial or anterior face of tibia **12** is also resected so as to receive mounting flange **512**. Once mounting flange **512** is positioned, screws are advanced through holes **514** and **515** into the lateral, medial, or anterior side of tibia **12** so as to directly screw condylar implant **500** to tibia **12**.

In an alternative embodiment, it is also appreciated that stem **304** of condylar implant **300** can be mounted on bottom surface **504** of condylar implant **500**. In this embodiment, condylar implant **500** can be mounted both through the use of stem **512**, as discussed above, and by screws passing through holes **514** and **515**.

Depicted in FIGS. 27A and B is still another alternative embodiment of a condylar implant **530**. Condylar implant **530** comprises a bearing plate **532** having a top articular surface **534** and an opposing bottom surface **536** which each extend between an anterior end **538** and a posterior end **540**. A pocket **542** is formed on bottom surface **536**. Pocket **542** is bounded by a floor **544** and a sidewall **546** upstanding around the perimeter of floor **544**. Extending through sidewall **546** at anterior end **538** are a pair of spaced apart holes **548** and **550**.

Centrally projecting from floor **544** is a post **552** having substantially t-shaped configuration. In alternative embodiments post **552** can be any desired configuration. Pocket **542** is designed to partially receive an inlay of bone ingrowth material (not shown) so as to encircle post **552**.

During use, a slot complementary to post **552** is formed on the resected facet of the tibia. Condylar implant **530** is then positioned on the resected facet so that post **552** is received within the slot. Screws are then passed through **550** and **552** at a downward angle so as to penetrate into the tibia. Here it is appreciated that the inlay of bone ingrowth material will also need to have corresponding holes extending therethrough so that the screws can pass through the bone ingrowth material into the tibia.

The present invention may be embodied in other specific forms without departing from its spirit or essential characteristics. The described embodiments are to be considered in all respects only as illustrative and not restrictive. The scope of the invention is, therefore, indicated by the appended claims rather than by the foregoing description. All changes which come within the meaning and range of equivalency of the claims are to be embraced within their scope.

What is claimed is:

1. A condylar implant for mounting on the proximal end of a tibia, the condylar implant comprising:

a bearing plate having a top articular surface and an opposing bottom surface, the top articular surface being adapted to mate with a femoral condyle;

a stem downwardly projecting from the bottom surface of the bearing plate, the stem having a proximal end formed on the bottom surface of the bearing plate and an opposing distal end that is spaced apart from the bottom surface of the bearing plate with a central longitudinal axis

16

extending through the stem between the proximal end and the distal end thereof, the stem being oriented so that the central longitudinal axis extending from the proximal end of the stem intersects with and passes through the bearing plate adjacent to the proximal end of the stem and an inside angle is formed between the central longitudinal axis of the stem and the bottom surface of the bearing plate in a range between about 30° to about 80°, the stem and the bearing plate being fabricated as a monolithic piece of material so that there is no mechanical connection removably coupling the stem to the bearing plate; and

means for connecting a fastener to the stem.

2. A condylar implant as recited in claim 1, wherein the bearing plate comprises:

a lower bearing plate having the stem projecting therefrom; and

an upper bearing plate having the top articular surface formed thereon, one of the lower bearing plate and upper bearing plate having a track formed thereon while the other has a key that slidably rides within the track.

3. A condylar implant as recited in claim 2, wherein the key has the configuration of a tenon while the track comprises a mortis configured to slidably receive the tenon.

4. A condylar implant as recited in claim 1, further comprising:

the bottom surface of the bearing plate having a pocket formed thereon; and

an inlay being secured within the pocket.

5. A condylar implant as recited in claim 4, wherein the pocket and the inlay encircle the stem.

6. A condylar implant as recited in claim 1, wherein the means for connecting the fastener to the stem comprises a threaded socket formed on the stem.

7. A condylar implant as recited in claim 1, wherein the bearing plate has a maximum thickness in a range between about 2 mm to about 10 mm.

8. A condylar implant as recited in claim 1, wherein the stem has a length in a range between about 2 mm to about 6 mm.

9. A condylar implant as recited in claim 1, further comprising a mounting flange downwardly projecting from the bottom surface of the bearing plate at a perimeter edge of the bearing plate, the mounting flange bounding at least one hole extending therethrough.

10. A condylar implant as recited in claim 1, wherein the stem is oriented so that a distance from the bottom surface of the bearing plate to the central longitudinal axis at the distal end of the stem is greater than a distance from the bottom surface of the bearing plate to the central longitudinal axis at the proximal end of the stem.

11. A condylar implant as recited in claim 1, wherein the stem is oriented so that a substantially V-shaped notch is formed between the bottom surface of the bearing plate and an exterior surface of the stem.

12. A condylar implant system comprising:

a condylar implant comprising:

a bearing plate having a top articular surface and an opposing bottom surface, the top articular surface being adapted to mate with a femoral condyle;

a stem downwardly projecting from the bottom surface of the bearing plate; and

means for connecting a fastener to the stem;

a fastener mechanically engaging with the stem; and

a tubular bone anchor removably encircling at least a portion of the fastener, wherein the fastener has external threads that rotate in a first direction and the bone anchor

17

has external threads that rotate in a second direction that is opposite of the first direction.

13. A condylar implant system as recited in claim 12, wherein the fastener comprises a shaft having threads formed thereon.

14. A condylar implant system as recited in claim 13, further comprising an enlarged head integrally formed on the shaft or an enlarged nut removably mountable on the shaft.

15. A condylar implant system as recited in claim 12, wherein the bone anchor has an interior surface bounding a channel extending between a first end and an opposing second end, the first end terminating at a first end face, the channel comprising a first channel portion extending from the first end, a second channel portion extending from the second end, and a radially inwardly projecting shoulder disposed between the first channel portion and the second channel portion.

16. A condylar implant system for use on the proximal end of a tibia, the system comprising:

a condylar implant comprising a bearing plate having a top articular surface and an opposing bottom surface;

an elongated fastener selectively mountable to the bottom surface of the bearing plate; and

a tubular bone anchor removably encircling at least a portion of the fastener, the bone anchor having an interior surface bounding a channel extending between a first end and an opposing second end, the first end terminating at a first end face, the channel comprising a first channel portion extending from the first end, a second channel portion extending from the second end, and a radially inwardly projecting shoulder disposed between the first channel portion and the second channel portion, the bone anchor further comprising one or more threads or barbs formed on an exterior surface thereof.

17. A condylar implant system as recited in claim 16, wherein the condylar implant further comprises a stem projecting from the bottom surface of the bearing plate, the stem being configured to mate with the fastener.

18. A condylar implant system as recited in claim 16, wherein the fastener mounts to the bearing plate so as to form an inside angle between the fastener and the bottom surface of the bearing plate in a range between about 30° to about 80°.

19. A condylar implant system as recited in claim 16, wherein the bearing plate comprises:

a lower bearing plate having the bottom surface formed thereon; and

an upper bearing plate having the top articular surface formed thereon, one of the lower bearing plate and upper bearing plate having a track formed thereon while the other has a key that slidably rides within the track.

20. A condylar implant system as recited in claim 16, further comprising:

the bottom surface of the bearing plate having at least one pocket formed thereon; and

an inlay comprised of a porous bone ingrowth material being secured within the at least one pocket.

21. A condylar implant system as recited in claim 16, wherein the fastener comprises an elongated shaft having a length in a range between about 5 mm to about 15 mm.

22. A condylar implant system as recited in claim 16, wherein the fastener comprises an elongated shaft having an enlarged head integrally formed thereon.

23. A condylar implant system as recited in claim 16, further comprising an enlarged nut removably mountable to the fastener.

24. A condylar implant system as recited in claim 16, wherein the fastener has at least one helical thread that

18

engages with the condylar implant and the bone anchor has at least one external helical thread, the helical thread of the bone anchor rotating in a direction opposite of the helical thread of the fastener.

25. A condylar implant system as recited in claim 16, wherein the fastener comprises a shaft having an enlarged head integrally formed thereon, the head being biased against the shoulder of the bone anchor.

26. A condylar implant system as recited in claim 16, further comprising an enlarged nut removably mounted on the fastener and biased against the shoulder of the bone anchor.

27. A condylar implant system as recited in claim 16, further comprising a drive rod integrally formed with the fastener, a plurality of spaced apart annular breaking grooves being formed at the intersection between the fastener and the drive rod.

28. A condylar implant system for use on the proximal end of a tibia, the system comprising:

a condylar implant comprising a bearing plate having a top articular surface and an opposing bottom surface, a stem projecting from the bottom surface of the bearing plate;

an elongated fastener configured to selectively mate with the stem;

a tubular bone anchor removably encircling at least a portion of the fastener, the bone anchor having an exterior surface with at least one helical thread radially outwardly projecting therefrom; and

a nut having a passage extending completely therethrough, the nut being removably threaded onto the fastener.

29. A condylar implant system as recited in claim 28, wherein the bearing plate and the stem comprise a unitary member that is fabricated from a single piece of material.

30. A condylar implant system for use on the proximal end of a tibia, the system comprising:

a condylar implant comprising a bearing plate having a top articular surface and an opposing bottom surface;

an elongated fastener having a first end and an opposing second end, the first end being removably threaded to the bottom surface of the bearing plate without extending through the bearing plate; and

a nut having a passage extending completely therethrough, the nut being removably threaded onto the fastener from the second end of the fastener.

31. A condylar implant system as recited in claim 30, further comprising a tubular bone anchor removably encircling at least a portion of the fastener.

32. A condylar implant system as recited in claim 30, wherein the bone anchor has an exterior surface with at least one helical thread radially outwardly projecting therefrom.

33. A condylar implant system for use on the proximal end of a tibia, the system comprising:

a condylar implant comprising a bearing plate having a top articular surface and an opposing bottom surface, the top articular surface being adapted to mate with a femoral condyle;

a fastener comprising an elongated shaft having a first end and an opposing second end, the first end being removably mounted to the bottom surface of the bearing plate, an enlarged head being permanently fixed on the shaft or an enlarged nut being removably mountable onto the shaft; and

a tubular bone anchor removably encircling at least a portion of the fastener, at least one or more threads or barbs being formed on an exterior surface of the bone anchor.